

FIRST AMENDMENT
TO
DECLARATION
OF
PROTECTIVE COVENANTS
FOR
FOXWOOD AT PANTHER RIDGE

February THIS FIRST AMENDMENT (the "First Amendment") is made as of the 5th day of 1998, by PANTHER RIDGE COMMUNITIES, LTD., a Florida limited partnership (the "Declarant").

W I T N E S S E T H:

WHEREAS, Declarant has heretofore executed and filed of record, that certain Declaration of Protective Covenants for Foxwood at Panther Ridge, dated November 14, 1997, and, recorded in O.R. Book 1535, Page 4540, of the Public Records of Manatee County, Florida, as amended and supplemented (the "Declaration"); and

WHEREAS, Declarant wishes to amend the Declaration in accordance with Section 9.05(a) thereof, and to submit certain additional land owned by Declarant to the Declaration pursuant to Section 2.01 thereof and to withdraw certain land previously submitted to the Declaration pursuant to Section 2.02 thereof;

NOW, THEREFORE, Declarant hereby amends the Declaration as follows:

1. Recitals and Definitions. The recitals contained hereinabove are true and correct and are incorporated herein by reference. Capitalized terms used herein shall have the meaning given them in the Declaration unless the context otherwise clearly indicates.

2. Property Subject to Declaration. The term Property shall henceforth apply to all and singular those lands described on Exhibit A attached to this First Amendment, and made a part hereof. Exhibit A to this First Amendment hereby amends, supersedes and replaces the Exhibit A attached to the Declaration as originally recorded, for all purposes. The lands described on Exhibit A to this First Amendment are hereby made subject to the operation and effect of the Declaration, and are and shall be held, transferred, sold, conveyed, leased, occupied and used subject to the covenants, restrictions, conditions, easements, limitations, terms, obligations, charges and liens set forth in the Declaration, as heretofore, hereby and hereafter amended. The Property as described on Exhibit A to this First Amendment forms the Subdivision. To the extent any land described on Exhibit A to the Declaration as originally recorded is not included within the lands described on Exhibit A to this First Amendment, such lands are hereby withdrawn from the operation and effect of the Declaration pursuant to Section 2.02 of the Declaration.

3. **Amended Site Plan.** There is attached hereto as Exhibit B and made a part hereof, an amended Site Plan for the Subdivision. The Site Plan attached to this First Amendment amends, supersedes and replaces the Site Plan attached to the Declaration as originally recorded, for all purposes, and hereafter the term Site Plan shall be held and deemed to refer to the Site Plan attached as Exhibit B to this First Amendment.

4. **Covenant and Ratification.** Declarant covenants that the Turnover Date has not occurred. The Declaration as amended hereby is hereby ratified and confirmed.

IN WITNESS WHEREOF, Declarant has caused these presents to be executed in its name by its general partner thereunto duly authorized as of the day and year first above written.

Signed, sealed and delivered
in the presence of:

**PANTHER RIDGE COMMUNITIES, LTD, a
Florida limited partnership**

Marilyn E. Remick
Witness

Marilyn E. Remick
Print Name of Witness

Debra L. Pritchard
Witness

Debra L. Pritchard
Print Name of Witness

By: **PANTHER RIDGE COMMUNITIES, INC.**
a Florida corporation, its
general partner

By: Jeffrey D. Gravely
Jeffrey D. Gravely, its Vice President
3651 Cortez Road West
Suite 300
Bradenton, FL 34210

**STATE OF FLORIDA
COUNTY OF MANATEE**

The foregoing instrument was acknowledged before me this 5th day of February, 1998, by Jeffrey D. Gravely, as Vice President of Panther Ridge Communities, Inc., a Florida corporation, on behalf of the corporation, as general partner of Panther Ridge Communities, Ltd., a Florida limited partnership, on behalf of the partnership, (X) who is personally known to me or () who has produced _____ as identification.

Pamela Jo Tatman
Notary Public
My Commission Expires: 10-30-2001

This instrument prepared by:
David K. Deitrich, Esq.
Deitrich & St. Paul, P.A.
1111 Third Avenue West, Suite 350
Bradenton, FL 34205

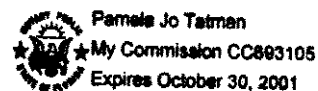



BK 1543 PG 7172 3 of 75

201 5th Avenue Drive East
Post Office Box 9448
Bradenton, Florida 34206

(941) 748-8080
Fax (941) 748-3316
Survey Fax (941) 748-3747
E-mail: zns@manatee-cc.com
Web Page: www.manatee-cc.com/zns/

JANUARY 28, 1998

FOXWOOD

DESCRIPTION: FOXWOOD PARK

A PORTION OF TRACT 49, SECTION 32, TOWNSHIP 35 SOUTH, RANGE 20 EAST, POMELLO PARK, AS PER PLAT THEREOF, RECORDED IN PLAT BOOK 6, PAGE 61, OF PUBLIC RECORDS OF MANATEE COUNTY, FLORIDA, BEING MORE PARTICULARLY DESCRIBED AS FOLLOWS:

FROM THE NORTHEAST CORNER OF SAID SECTION 32, TOWNSHIP 35 SOUTH, RANGE 20 EAST, RUN S 89°18'18" W, A DISTANCE OF 1019.43 FEET TO THE POINT OF BEGINNING; THENCE S 00°28'15" E, A DISTANCE OF 682.77 FEET; THENCE N 88°51'51" W ALONG THE SOUTH LINE OF SAID TRACT 49, A DISTANCE OF 266.66 FEET TO A POINT ON THE ARC OF A CURVE TO THE LEFT WHOSE RADIUS POINT LIES SOUTH 84°14'15" W, A DISTANCE OF 1325.00 FEET; THENCE NORTHERLY ALONG THE ARC OF SAID CURVE TO THE LEFT, A DISTANCE OF 79.08 FEET THROUGH A CENTRAL ANGLE OF 03°25'11" TO A POINT OF REVERSE CURVATURE WITH A CURVE TO THE RIGHT HAVING A RADIUS OF 1275.00 FEET; THENCE NORTHERLY ALONG THE ARC OF SAID CURVE TO THE RIGHT, A DISTANCE OF 330.90 FEET THROUGH A CENTRAL ANGLE OF 14°52'11" TO A POINT OF REVERSE CURVATURE WITH A CURVE TO THE LEFT HAVING A RADIUS OF 1325.00 FEET; THENCE NORTHERLY ALONG THE ARC OF SAID CURVE TO THE LEFT, A DISTANCE OF 142.40 FEET THROUGH A CENTRAL ANGLE OF 06°09'27" TO THE POINT OF TANGENCY; THENCE N 00°28'12" W, A DISTANCE OF 142.81 FEET; THENCE S 88°44'41" E, A DISTANCE OF 115.87 FEET TO THE POINT OF CURVATURE OF A CURVE TO THE RIGHT HAVING A RADIUS OF 1275.00 FEET; THENCE EASTERLY ALONG THE ARC OF SAID CURVE TO THE RIGHT, A DISTANCE OF 137.02 FEET THROUGH A CENTRAL ANGLE OF 06°09'27" TO THE POINT OF BEGINNING.

LESS AND EXCEPT ANY PORTION OF THE ABOVE DESCRIBED PARCEL WHICH FALLS WITHIN THE PLATTED ROAD RIGHTS OF WAY AS PER PLAT OF POMELLO PARK RECORDED IN PLAT BOOK 6, PAGE 61 OF THE PUBLIC RECORDS OF MANATEE COUNTY, FLORIDA.

EXHIBIT A

AE

Zoller,

Najjar &

Shroyer, Inc.

BK 1543 PG 7173 4 of 75

201 5th Avenue Drive East
Post Office Box 9448
Bradenton, Florida 34206

(941) 748-8080
Fax (941) 748-3316
Survey Fax (941) 748-3747
E-mail: zns@manatee-cc.com
Web Page: www.manatee-cc.com/zns/

OCTOBER 17, 1997

FOXWOOD

DESCRIPTION: PARCEL 7

A PORTION OF TRACTS 61 AND 62, SECTION 32, TOWNSHIP 35 SOUTH, RANGE 20 EAST, POMELLO PARK, AS PER PLAT THEREOF, RECORDED IN PLAT BOOK 6, PAGE 61 OF THE PUBLIC RECORDS OF MANATEE COUNTY, FLORIDA, BEING MORE PARTICULARLY DESCRIBED AS FOLLOWS:

FROM THE NORTHEAST CORNER OF SECTION 32, TOWNSHIP 35 SOUTH, RANGE 20 EAST, RUN SOUTH 00°31'46" WEST ALONG THE EAST LINE OF SAID SECTION 32, A DISTANCE OF 1455.22 FEET TO THE POINT OF BEGINNING; THENCE SOUTH 00°28'19" EAST, A DISTANCE OF 276.13 FEET; THENCE SOUTH 40°02'53" WEST, A DISTANCE OF 739.77 FEET; THENCE NORTH 52°44'42" WEST, A DISTANCE OF 227.02 FEET; THENCE NORTH 00°28'15" WEST ALONG THE WEST LINE OF SAID TRACT 62, A DISTANCE OF 691.72 FEET; THENCE SOUTH 88°59'00" EAST, A DISTANCE OF 158.72 FEET; THENCE SOUTH 01°01'00" WEST, A DISTANCE OF 25.00 FEET; THENCE SOUTH 88°59'00" EAST, A DISTANCE OF 40.00 FEET; THENCE NORTH 01°01'00" EAST, A DISTANCE OF 50.00 FEET; THENCE SOUTH 88°59'00" EAST, A DISTANCE OF 461.04 FEET TO THE POINT OF BEGINNING.

LESS AND EXCEPT ANY PORTION OF THE ABOVE DESCRIBED PARCEL WHICH FALLS WITHIN THE PLATTED ROAD RIGHTS OF WAY AS PER PLAT OF POMELLO PARK RECORDED IN PLAT BOOK 6, PAGE 61 OF THE PUBLIC RECORDS OF MANATEE COUNTY, FLORIDA.

Zoller,

BK 1543 PG 7174 5 of 75

Najjar &

Shroyer, Inc.

201 5th Avenue Drive East
Post Office Box 9448
Bradenton, Florida 34206

(941) 748-8080
Fax (941) 748-3316
Survey Fax (941) 748-3747
E-mail: zns@manatee-cc.com
Web Page: www.manatee-cc.com/zns/

DECEMBER 2, 1997

FOXWOOD

DESCRIPTION: PARCEL 8

A PORTION OF TRACTS 52 AND 61, SECTION 32, TOWNSHIP 35 SOUTH, RANGE 20 EAST, POMELLO PARK, AS PER PLAT THEREOF, RECORDED IN PLAT BOOK 6, PAGE 61 OF THE PUBLIC RECORDS OF MANATEE COUNTY, FLORIDA, BEING MORE PARTICULARLY DESCRIBED AS FOLLOWS:

FROM THE NORTHEAST CORNER OF SECTION 32, TOWNSHIP 35 SOUTH, RANGE 20 EAST, RUN S 16°44'49" W, A DISTANCE OF 2230.23 FEET TO THE POINT OF BEGINNING; THENCE S 52°44'42" E, A DISTANCE OF 227.02 FEET; THENCE S 42°38'04" W, A DISTANCE OF 731.73 FEET; THENCE N 89°40'00" W, A DISTANCE OF 339.75 FEET; THENCE N 00°28'12" W, A DISTANCE OF 139.07 FEET; THENCE N 89°31'48" E, A DISTANCE OF 50.00 FEET; THENCE N 00°28'12" W, A DISTANCE OF 40.00 FEET; THENCE S 89°31'48" W, A DISTANCE OF 25.00 FEET; THENCE N 00°28'12" W, A DISTANCE OF 429.86 FEET TO THE P.C. OF A CURVE TO THE RIGHT WHOSE RADIUS LIES 475.00 FEET; THENCE NORTHERLY ALONG THE ARC OF SAID CURVE TO THE RIGHT, A DISTANCE OF 76.35 FEET THROUGH A CENTRAL ANGLE OF 09°12'34"; THENCE S 89°06'10" E ALONG THE NORTH LINE OF SAID TRACT 52, A DISTANCE OF 629.25 FEET TO THE POINT OF BEGINNING.

LESS AND EXCEPT ANY PORTION OF THE ABOVE DESCRIBED PARCEL WHICH FALLS WITHIN THE PLATTED ROAD RIGHTS OF WAY AS PER PLAT OF POMELLO PARK RECORDED IN PLAT BOOK 6, PAGE 61 OF THE PUBLIC RECORDS OF MANATEE COUNTY, FLORIDA.

OCTOBER 7, 1997

FOXWOOD

DESCRIPTION: PARCEL 9

A PORTION OF TRACT 51, SECTION 32, TOWNSHIP 35 SOUTH, RANGE 20 EAST, POMELLO PARK, AS PER PLAT THEREOF, RECORDED IN PLAT BOOK 6, PAGE 61 OF THE PUBLIC RECORDS OF MANATEE COUNTY, FLORIDA, BEING MORE PARTICULARLY DESCRIBED AS FOLLOWS:

FROM THE NORTHEAST CORNER OF SECTION 32, TOWNSHIP 35 SOUTH, RANGE 20 EAST, RUN S 24°10'46" W, A DISTANCE OF 1582.81 FEET TO THE POINT OF BEGINNING; THENCE S 00°28'15" E ALONG THE EAST LINE OF SAID TRACT 51, A DISTANCE OF 691.72 FEET; THENCE N 89°06'10" W ALONG THE SOUTH LINE OF SAID TRACT 51, A DISTANCE OF 629.25 FEET TO A POINT ON THE ARC OF A CURVE TO THE RIGHT WHOSE RADIUS POINT LIES S 81°15'38" E, A DISTANCE OF 475.00 FEET; THENCE NORTHERLY ALONG THE ARC OF SAID CURVE TO THE RIGHT, A DISTANCE OF 174.35 FEET THROUGH A CENTRAL ANGLE OF 21°01'50" TO A POINT OF REVERSE CURVATURE WITH A CURVE TO THE LEFT HAVING A RADIUS OF 250.00 FEET; THENCE NORTHERLY ALONG THE ARC OF SAID CURVE TO THE LEFT, A DISTANCE OF 300.67 FEET THROUGH A CENTRAL ANGLE OF 68°54'33" TO A POINT OF REVERSE CURVATURE WITH A CURVE TO THE RIGHT HAVING A RADIUS OF 200.00 FEET; THENCE NORTHERLY ALONG THE ARC OF SAID CURVE TO THE RIGHT, A DISTANCE OF 134.98 FEET THROUGH A CENTRAL ANGLE OF 38°40'09" TO THE POINT OF TANGENCY; THENCE N 00°28'12" W, A DISTANCE OF 122.91 FEET; THENCE S 88°59'00" E, A DISTANCE OF 635.40 FEET TO THE POINT OF BEGINNING.

OCTOBER 8, 1997

FOXWOOD

DESCRIPTION: PARCEL 10

A PORTION OF TRACT 50, SECTION 32, TOWNSHIP 35 SOUTH, RANGE 20 EAST, POMELLO PARK, AS PER PLAT THEREOF, RECORDED IN PLAT BOOK 6, PAGE 61 OF THE PUBLIC RECORDS OF MANATEE COUNTY, FLORIDA, BEING MORE PARTICULARLY DESCRIBED AS FOLLOWS:

FROM THE NORTHEAST CORNER OF SECTION 32, TOWNSHIP 35 SOUTH, RANGE 20 EAST, RUN S $31^{\circ}47'51''$ W, A DISTANCE OF 1236.52 FEET TO THE POINT OF BEGINNING; THENCE S $00^{\circ}28'15''$ E ALONG THE EAST LINE OF SAID TRACT 50, A DISTANCE OF 343.01 FEET; THENCE N $88^{\circ}59'00''$ W, A DISTANCE OF 635.39 FEET; THENCE N $00^{\circ}28'12''$ W, A DISTANCE OF 291.68 FEET TO THE POINT OF CURVATURE WITH A CURVE TO THE LEFT HAVING A RADIUS OF 1275.00 FEET; THENCE NORTHERLY ALONG THE ARC OF SAID CURVE TO THE LEFT, A DISTANCE OF 52.64 FEET THROUGH A CENTRAL ANGLE OF $02^{\circ}21'55''$; THENCE S $88^{\circ}51'51''$ E, DISTANCE OF 634.34 FEET TO THE POINT OF BEGINNING.

Handwritten signature or mark

OCTOBER 8, 1997

FOXWOOD

DESCRIPTION: PARCEL 11

A PORTION OF TRACT 50, SECTION 32, TOWNSHIP 35 SOUTH, RANGE 20 EAST, POMELLO PARK, AS PER PLAT THEREOF, RECORDED IN PLAT BOOK 6, PAGE 61 OF THE PUBLIC RECORDS OF MANATEE COUNTY, FLORIDA, BEING MORE PARTICULARLY DESCRIBED AS FOLLOWS:

FROM THE NORTHEAST CORNER OF SECTION 32, TOWNSHIP 35 SOUTH, RANGE 20 EAST, RUN S 42°58'51" W, A DISTANCE OF 959.89 FEET TO THE POINT OF BEGINNING; THENCE S 00°28'15" E ALONG THE EAST LINE OF SAID TRACT 50, A DISTANCE OF 348.71 FEET; THENCE NORTH 88°51'51" W, A DISTANCE OF 634.34 FEET TO A POINT ON THE ARC OF A CURVE TO THE RIGHT WHOSE RADIUS POINT LIES S 88°06'16" E, A DISTANCE OF 1275.00 FEET; THENCE NORTHERLY ALONG THE ARC OF SAID CURVE TO THE RIGHT, A DISTANCE OF 81.54 FEET THROUGH A CENTRAL ANGLE OF 03°39'51" TO A POINT OF REVERSE CURVATURE WITH A CURVE TO THE LEFT HAVING A RADIUS OF 1325.00 FEET; THENCE NORTHERLY ALONG THE ARC OF SAID CURVE TO THE LEFT, A DISTANCE OF 264.79 FEET THROUGH A CENTRAL ANGLE OF 11°27'00"; THENCE S 88°51'51" E ALONG THE NORTH LINE OF SAID TRACT 50, A DISTANCE OF 626.06 FEET TO THE POINT OF BEGINNING.

R

Zoller,

Najjar &

Shroyer, Inc.

BK 1543 PG 7178 9 of 75

201 5th Avenue Drive East
Post Office Box 9448
Bradenton, Florida 34206

(941) 748-8080
Fax (941) 748-3316
Survey Fax (941) 748-3747
E-mail: zns@manatee-cc.com
Web Page: www.manatee-cc.com/zns/

JANUARY 21, 1998

FOXWOOD

DESCRIPTION: PARCEL 14

A PORTION OF TRACT 56, SECTION 29, TOWNSHIP 35 SOUTH, RANGE 20 EAST, POMELLO PARK, AS PER PLAT THEREOF, RECORDED IN PLAT BOOK 6, PAGE 61 OF THE PUBLIC RECORDS OF MANATEE COUNTY, FLORIDA, BEING MORE PARTICULARLY DESCRIBED AS FOLLOWS:

FROM THE SOUTHEAST CORNER OF SECTION 29, TOWNSHIP 35 SOUTH, RANGE 20 EAST, RUN N 87°51'56" W, A DISTANCE OF 1020.48 FEET TO THE POINT OF BEGINNING, ALSO BEING A POINT ON THE ARC OF A CURVE TO THE RIGHT WHOSE RADIUS POINT LIES N 06°39'14" E, A DISTANCE OF 1275.00 FEET; THENCE WESTERLY ALONG THE ARC OF SAID CURVE TO THE RIGHT, A DISTANCE OF 16.89 FEET THROUGH A CENTRAL ANGLE OF 00°45'32" TO A POINT OF REVERSE CURVATURE WITH A CURVE TO THE LEFT HAVING A RADIUS OF 1325.00 FEET; THENCE WESTERLY ALONG THE ARC OF SAID CURVE TO THE LEFT, A DISTANCE OF 142.40 FEET THROUGH A CENTRAL ANGLE OF 06°09'27" TO THE POINT OF TANGENCY; THENCE N 88°44'41" W, A DISTANCE OF 117.08 FEET; THENCE N 00°14'23" E, A DISTANCE OF 480.08 FEET; THENCE S 88°44'41" E, A DISTANCE OF 636.71 FEET; THENCE S 37°00'00" W, A DISTANCE OF 602.92 FEET TO THE POINT OF BEGINNING.

LESS AND EXCEPT ANY PORTION OF THE ABOVE DESCRIBED PARCEL WHICH FALLS WITHIN THE PLATTED ROAD RIGHTS OF WAY AS PER PLAT OF POMELLO PARK RECORDED IN PLAT BOOK 6, PAGE 61 OF THE PUBLIC RECORDS OF MANATEE COUNTY, FLORIDA.

OCTOBER 8, 1997

FOXWOOD

DESCRIPTION: PARCEL 15

A PORTION OF TRACT 42, TRACT 55 AND TRACT 56, SECTION 29, TOWNSHIP 35 SOUTH, RANGE 20 EAST, POMELLO PARK, AS PER PLAT THEREOF, RECORDED IN PLAT BOOK 6, PAGE 61 OF THE PUBLIC RECORDS OF MANATEE COUNTY, FLORIDA, BEING MORE PARTICULARLY DESCRIBED AS FOLLOWS:

FROM THE SOUTHEAST CORNER OF SECTION 29, TOWNSHIP 35 SOUTH, RANGE 20 EAST, RUN N 51°39'43" W, A DISTANCE OF 837.52 FEET TO THE POINT OF BEGINNING; THENCE N 88°44'41" W, A DISTANCE OF 636.71 FEET; THENCE N 00°14'23" E, A DISTANCE 155.81 FEET TO THE POINT OF CURVATURE WITH A CURVE TO THE LEFT HAVING A RADIUS OF 525.00 FEET; THENCE NORTHERLY ALONG THE ARC OF SAID CURVE TO THE LEFT, A DISTANCE OF 307.64 FEET THROUGH A CENTRAL ANGLE OF 33°34'26" TO A POINT OF REVERSE CURVATURE WITH A CURVE TO THE RIGHT HAVING A RADIUS OF 475.00; THENCE NORTHERLY ALONG THE ARC OF SAID CURVE TO THE RIGHT, A DISTANCE OF 313.08 FEET TO THE END OF SAID CURVE; THENCE S 69°03'35" E, A DISTANCE OF 858.74 FEET; THENCE S 00°22'58" W ALONG THE EAST LINE OF SAID TRACT 55 AND TRACT 56, A DISTANCE OF 451.27 FEET TO THE POINT OF BEGINNING.

LESS AND EXCEPT ANY PORTION OF THE ABOVE DESCRIBED PARCEL WHICH FALLS WITHIN THE PLATTED ROAD RIGHTS OF WAY AS PER PLAT OF POMELLO PARK RECORDED IN PLAT BOOK 6, PAGE 61 OF THE PUBLIC RECORDS OF MANATEE COUNTY, FLORIDA.

BZ

Zoller,

Najjar &

Shroyer, Inc.

BK 1543 PG 7180 11 of 75

201 5th Avenue Drive East
Post Office Box 9448
Bradenton, Florida 34206

(941) 748-8080
Fax (941) 748-3316
Survey Fax (941) 748-3747
E-mail: zns@manatee-cc.com
Web Page: www.manatee-cc.com/zns/

OCTOBER 21, 1997

FOXWOOD

DESCRIPTION: PARCEL 16

A PORTION OF TRACTS 38, 39, 42 AND 43, SECTION 29, TOWNSHIP 35 SOUTH, RANGE 20 EAST, POMELLO PARK, AS PER PLAT THEREOF, RECORDED IN PLAT BOOK 6, PAGE 61 OF THE PUBLIC RECORDS OF MANATEE COUNTY, FLORIDA, BEING MORE PARTICULARLY DESCRIBED AS FOLLOWS:

FROM THE SOUTHEAST CORNER OF SECTION 29, TOWNSHIP 35 SOUTH, RANGE 20 EAST, RUN N 55°05'05" W, A DISTANCE OF 1777.13 FEET TO THE POINT OF BEGINNING; THENCE N 88°44'41" W, A DISTANCE OF 1185.03 FEET; THENCE N 00°02'46" W, A DISTANCE OF 688.64 FEET; THENCE S 69°03'35" E, A DISTANCE OF 1218.58 FEET TO A POINT ON THE ARC OF A CURVE TO THE RIGHT WHOSE RADIUS POINT LIES N 85°27'14" W, A DISTANCE OF 45.00 FEET; THENCE SOUTHERLY ON THE ARC OF SAID CURVE TO THE RIGHT, A DISTANCE OF 1.08 FEET THROUGH A CENTAL ANGLE OF 01°22'39" TO A POINT OF REVERSE CURVATURE WITH A CURVE TO THE LEFT HAVING A RADIUS OF 525.00 FEET; THENCE SOUTHERLY ALONG THE ARC OF SAID CURVE TO THE LEFT, A DISTANCE OF 285.51 FEET THROUGH A CENTRAL ANGLE OF 31°09'33" TO THE END OF SAID CURVE ALSO BEING THE POINT OF BEGINNING.

LESS AND EXCEPT ANY PORTION OF THE ABOVE DESCRIBED PARCEL WHICH FALLS WITHIN THE PLATTED ROAD RIGHTS OF WAY AS PER PLAT OF POMELLO PARK RECORDED IN PLAT BOOK 6, PAGE 61 OF THE PUBLIC RECORDS OF MANATEE COUNTY, FLORIDA.

PL

OCTOBER 8, 1997

FOXWOOD

DESCRIPTION: PARCEL 17

A PORTION OF TRACTS 41 AND 42, SECTION 29, TOWNSHIP 35 SOUTH, RANGE 20 EAST, POMELLO PARK, AS PER PLAT THEREOF, RECORDED IN PLAT BOOK 6, PAGE 61 OF THE PUBLIC RECORDS OF MANATEE COUNTY, FLORIDA, BEING MORE PARTICULARLY DESCRIBED AS FOLLOWS:

FROM THE SOUTHEAST CORNER OF SECTION 29, TOWNSHIP 35 SOUTH, RANGE 20 EAST, RUN N 88°44'41" W ALONG THE SOUTH LINE OF SAID SECTION 29, A DISTANCE OF 1320.91 FEET; THENCE N 00°14'23" E ALONG THE WEST LINE OF THE SOUTHEAST 1/4 OF THE SOUTHEAST 1/4 OF SAID SECTION 29, A DISTANCE OF 505.52 FEET; THENCE N 89°45'37" W, A DISTANCE OF 25.00 FEET TO THE POINT OF BEGINNING; THENCE N 88°44'41" W, A DISTANCE OF 636.71 FEET; THENCE N 00°05'48" E, A DISTANCE OF 480.10 FEET; THENCE S 88°44'41" E, A DISTANCE OF 522.11 FEET TO A POINT ON THE ARC OF A CURVE TO THE LEFT HAVING A RADIUS POINT N 64°45'52" E, A DISTANCE OF 1275.00 FEET; THENCE SOUTHERLY ALONG THE ARC OF SAID CURVE TO THE LEFT, A DISTANCE OF 268.79 FEET THROUGH A CENTRAL ANGLE OF 12°04'43" TO A POINT OF REVERSE CURVATURE WITH A CURVE TO THE RIGHT HAVING A RADIUS OF 1275.00 FEET; THENCE SOUTHERLY ALONG THE ARC OF SAID CURVE TO THE RIGHT, A DISTANCE OF 268.79 FEET THROUGH A CENTRAL ANGLE OF 12°04'43" TO THE POINT OF TANGENCY; THENCE S 00°14'23" W, A DISTANCE OF 154.93 FEET TO THE POINT OF BEGINNING.

11

OCTOBER 8, 1997

FOXWOOD

DESCRIPTION: PARCEL 18

A PORTION OF TRACT 41, SECTION 29, TOWNSHIP 35 SOUTH, RANGE 20 EAST, POMELLO PARK, AS PER PLAT THEREOF, RECORDED IN PLAT BOOK 6, PAGE 61 OF THE PUBLIC RECORDS OF MANATEE COUNTY, FLORIDA, BEING MORE PARTICULARLY DESCRIBED AS FOLLOWS:

FROM THE SOUTHEAST CORNER OF SECTION 29, TOWNSHIP 35 SOUTH, RANGE 20 EAST, RUN N 87°40'51" W, A DISTANCE OF 1346.59 FEET TO THE POINT OF BEGINNING; THENCE N 88°44'41" W, A DISTANCE OF 193.72 FEET TO A POINT OF CURVATURE WITH A CURVE TO THE RIGHT HAVING A RADIUS OF 1275.00 FEET; THENCE WESTERLY ALONG THE ARC OF SAID CURVE TO THE RIGHT, A DISTANCE OF 137.02 FEET THROUGH A CENTRAL ANGLE OF 06°09'27" TO A POINT OF REVERSE CURVATURE WITH A CURVE TO THE LEFT HAVING A RADIUS OF 1325.00 FEET; THENCE WESTERLY ALONG THE ARC OF SAID CURVE TO THE LEFT, A DISTANCE OF 305.82 FEET THROUGH A CENTRAL ANGLE OF 13°13'27"; THENCE N 00°05'48" E ALONG THE WEST LINE OF SAID TRACT 41, A DISTANCE OF 475.16 FEET; THENCE S 88°44'41" E, A DISTANCE OF 636.71 FEET; THENCE S 00°14'23" W, A DISTANCE OF 480.08 FEET TO THE POINT OF BEGINNING.

R

OCTOBER 8, 1997

FOXWOOD

DESCRIPTION: PARCEL 19

A PORTION OF TRACT 48, SECTION 32, TOWNSHIP 35 SOUTH, RANGE 20 EAST, POMELLO PARK, AS PER PLAT THEREOF, RECORDED IN PLAT BOOK 6, PAGE 61 OF THE PUBLIC RECORDS OF MANATEE COUNTY, FLORIDA, BEING MORE PARTICULARLY DESCRIBED AS FOLLOWS:

FROM THE NORTHEAST CORNER OF SECTION 32, TOWNSHIP 35 SOUTH, RANGE 20 EAST, RUN N 88°44'41" W ALONG THE NORTH LINE OF SAID SECTION 32, A DISTANCE OF 1345.17 FEET; THENCE S 01°15'19" W, A DISTANCE OF 25.00 FEET TO THE POINT OF BEGINNING; THENCE S 00°28'12" E, A DISTANCE OF 144.22 FEET TO THE POINT OF CURVATURE OF A CURVE TO THE RIGHT HAVING A RADIUS OF 1275.00 FEET; THENCE SOUTHERLY ALONG THE ARC OF SAID CURVE TO THE RIGHT, A DISTANCE OF 137.02 FEET THROUGH A CENTRAL ANGLE OF 06°09'27" TO A POINT OF REVERSE CURVATURE WITH A CURVE TO THE LEFT HAVING A RADIUS OF 1325.00 FEET; THENCE SOUTHERLY ALONG THE ARC OF SAID CURVE TO THE LEFT, A DISTANCE OF 343.87 FEET THROUGH A CENTRAL ANGLE OF 14°52'11" FOR A POINT OF REVERSE CURVATURE WITH A CURVE TO THE RIGHT HAVING A RADIUS OF 1275.00 FEET; THENCE SOUTHERLY ALONG THE ARC OF SAID CURVE TO THE RIGHT, A DISTANCE OF 70.05 FEET THROUGH A CENTRAL ANGLE OF 03°08'52"; THENCE N 88°51'51" W ALONG A PORTION OF THE SOUTH LINE OF SAID TRACT 48, A DISTANCE OF 644.41 FEET; THENCE N 00°28'08" W ALONG A PORTION OF THE WEST LINE OF SAID TRACT 48, A DISTANCE OF 699.17 FEET TO A POINT ON THE ARC OF A CURVE TO THE RIGHT WHOSE RADIUS POINT LIES S 06°02'06" E, A DISTANCE OF 1275.00 FEET; THENCE EASTERLY ALONG THE ARC OF SAID CURVE TO THE RIGHT, A DISTANCE OF 299.25 FEET THROUGH A CENTRAL ANGLE OF 13°26'52" TO A POINT OF REVERSE CURVATURE WITH A CURVE TO THE LEFT HAVING A RADIUS OF 1325.00 FEET; THENCE EASTERLY ALONG THE ARC OF SAID CURVE TO THE LEFT, A DISTANCE OF 142.40 FEET THROUGH A CENTRAL ANGLE OF 06°09'27" TO THE POINT OF TANGENCY; THENCE S 88°44'41" E, A DISTANCE OF 194.91 FEET TO THE POINT OF BEGINNING.

LESS AND EXCEPT ANY PORTION OF THE ABOVE DESCRIBED PARCEL WHICH FALLS WITHIN THE PLATTED ROAD RIGHTS OF WAY AS PER PLAT OF POMELLO PARK RECORDED IN PLAT BOOK 6, PAGE 61 OF THE PUBLIC RECORDS OF MANATEE COUNTY, FLORIDA.

OCTOBER 8, 1997

FOXWOOD

DESCRIPTION: PARCEL 20

A PORTION OF TRACT 47, SECTION 32, TOWNSHIP 35 SOUTH, RANGE 20 EAST, POMELLO PARK, AS PER PLAT THEREOF, RECORDED IN PLAT BOOK 6, PAGE 61 OF THE PUBLIC RECORDS OF MANATEE COUNTY, FLORIDA, BEING MORE PARTICULARLY DESCRIBED AS FOLLOWS:

FROM THE NORTHEAST CORNER OF SECTION 32, TOWNSHIP 35 SOUTH, RANGE 20 EAST, RUN S $62^{\circ}37'56''$ W, A DISTANCE OF 1498.43 FEET TO THE POINT OF BEGINNING, ALSO BEING A POINT ON THE ARC OF A CURVE TO THE RIGHT WHOSE RADIUS POINT LIES S $83^{\circ}57'56''$ W, A DISTANCE OF 1275.00 FEET; THENCE SOUTHERLY ALONG THE ARC OF SAID CURVE TO THE RIGHT, A DISTANCE OF 260.85 FEET THROUGH A CENTRAL ANGLE OF $11^{\circ}43'19''$ TO A POINT OF REVERSE CURVATURE WITH A CURVE TO THE LEFT HAVING A RADIUS OF 1325.00 FEET; THENCE SOUTHERLY ALONG THE ARC OF SAID CURVE TO THE LEFT, A DISTANCE OF 142.40 FEET THROUGH A CENTRAL ANGLE OF $06^{\circ}09'27''$ TO THE POINT OF TANGENCY; THENCE S $00^{\circ}28'12''$ E, A DISTANCE OF 290.38 FEET; THENCE N $88^{\circ}59'00''$ W, A DISTANCE OF 635.39 FEET; THENCE N $00^{\circ}28'08''$ W ALONG THE WEST LINE OF SAID TRACT 47, A DISTANCE OF 694.47 FEET; THENCE S $88^{\circ}51'51''$ E ALONG THE NORTH LINE OF SAID TRACT 47, A DISTANCE OF 644.41 FEET TO THE POINT OF BEGINNING.

LESS AND EXCEPT ANY PORTION OF THE ABOVE DESCRIBED PARCEL WHICH FALLS WITHIN THE PLATTED ROAD RIGHTS OF WAY AS PER PLAT OF POMELLO PARK RECORDED IN PLAT BOOK 6, PAGE 61 OF THE PUBLIC RECORDS OF MANATEE COUNTY, FLORIDA.

A



201 5th Avenue Drive East
Post Office Box 9448
Bradenton, Florida 34206

(941) 748-8080
Fax (941) 748-3316
Survey Fax (941) 748-3747
E-mail: zns@manatee-cc.com
Web Page: www.manatee-cc.com/zns/

NOVEMBER 20, 1997

FOXWOOD

DESCRIPTION: PARCEL 21

A PORTION OF TRACT 46, SECTION 32, TOWNSHIP 35 SOUTH, RANGE 20 EAST, POMELLO PARK AS PER PLAT THEREOF, RECORDED IN PLAT BOOK 6, PAGE 61 OF THE PUBLIC RECORDS OF MANATEE COUNTY, FLORIDA BEING MORE PARTICULARLY DESCRIBED AS FOLLOWS:

FROM THE NORTHEAST CORNER OF SAID SECTION 32, RUN N 88°44'41" W ALONG THE NORTH LINE OF SAID SECTION 32, A DISTANCE OF 1320.91 FEET TO THE WEST LINE OF THE EAST 1/2 OF THE NORTHEAST 1/4 OF SAID SECTION 32; THENCE S 00°28'12" E ALONG SAID WEST LINE, A DISTANCE OF 1460.57 FEET; THENCE S 89°31'48" W, A DISTANCE OF 25.00 FEET TO THE POINT OF BEGINNING; THENCE S 00°28'12" E, A DISTANCE OF 124.21 FEET TO THE P.C. OF A CURVE TO THE LEFT WITH A RADIUS OF 250.00 FEET; THENCE ALONG THE ARC OF SAID CURVE TO THE LEFT IN A SOUTHEASTERLY DIRECTION, A DISTANCE OF 168.73 FEET THROUGH A CENTRAL ANGLE OF 38°40'09" TO THE POINT OF REVERSE ON A CURVE TO THE RIGHT WITH A RADIUS OF 200.00 FEET; THENCE ALONG THE ARC OF SAID CURVE TO THE RIGHT IN A SOUTHEASTERLY DIRECTION, A DISTANCE OF 76.85 FEET THROUGH A CENTRAL ANGLE OF 22°00'57"; THENCE N 89°06'10" W, A DISTANCE OF 725.66 FEET TO THE WEST LINE OF SAID TRACT 46; THENCE N 00°28'08" W ALONG SAID WEST LINE, A DISTANCE OF 347.24 FEET; THENCE S 88°59'00" E, A DISTANCE OF 635.40 FEET TO THE POINT OF BEGINNING.

LESS AND EXCEPT A PORTION OF THE ABOVE DESCRIBED PARCEL WHICH FALLS WITHIN PLATTED ROAD RIGHTS OF WAY AS PER PLAT OF POMELLO PARK, RECORDED IN PLAT BOOK 6, PAGE 61 OF THE PUBLIC RECORDS OF MANATEE COUNTY, FLORIDA.

BN 1543 PG 7185 16 of 75

12.



201 5th Avenue Drive East
Post Office Box 9448
Bradenton, Florida 34206

(941) 748-8080
Fax (941) 748-3316
Survey Fax (941) 748-3747
E-mail: zns@manatee-cc.com
Web Page: www.manatee-cc.com/zns/

OCTOBER 30, 1997

FOXWOOD

DESCRIPTION: PARCEL 22

A PORTION OF TRACTS 46 AND 51, SECTION 32, TOWNSHIP 35 SOUTH, RANGE 20 EAST, POMELLO PARK AS PER PLAT THEREOF, RECORDED IN PLAT BOOK 6, PAGE 61 OF THE PUBLIC RECORDS OF MANATEE COUNTY, FLORIDA, BEING MORE PARTICULARLY DESCRIBED AS FOLLOWS:

FROM THE NORTHEAST CORNER OF SECTION 32, TOWNSHIP 35 SOUTH, RANGE 20 EAST, RUN S 34°53'12" W, A DISTANCE OF 2168.88 FEET TO THE POINT OF BEGINNING ALSO BEING A POINT ON THE ARC OF A CURVE TO THE RIGHT WHOSE RADIUS POINT LIES S 72°52'36" W, A DISTANCE OF 200.00 FEET; THENCE SOUTHERLY ALONG THE ARC OF SAID CURVE TO THE RIGHT, A DISTANCE OF 163.69 FEET THROUGH A CENTRAL ANGLE OF 46°53'36" TO A POINT OF REVERSE CURVATURE WITH A CURVE TO THE LEFT HAVING A RADIUS OF 525.00 FEET; THENCE SOUTHERLY ALONG THE ARC OF SAID CURVE TO THE LEFT, A DISTANCE OF 199.58 FEET THROUGH A CENTRAL ANGLE OF 21°46'53"; THENCE N 89°06'10" W ALONG A PORTION OF THE SOUTH LINE OF SAID TRACT 46, A DISTANCE OF 641.09 FEET; THENCE N 00°28'08" W ALONG A PORTION OF THE WEST LINE OF SAID TRACT 46, A DISTANCE OF 347.24 FEET; THENCE S 89°06'10" E, A DISTANCE OF 725.66 FEET TO THE POINT OF BEGINNING.

LESS AND EXCEPT A PORTION OF THE ABOVE DESCRIBED PARCEL WHICH FALLS WITHIN THE PLATTED ROAD RIGHTS OF WAY AS PER PLAT OF POMELLO PARK, RECORDED IN PLAT BOOK 6, PAGE 61 OF THE PUBLIC RECORDS OF MANATEE COUNTY, FLORIDA.

BN 1543 PG 7186 17 of 75

12.



201 5th Avenue Drive East
Post Office Box 9448
Bradenton, Florida 34206

(941) 748-8080
Fax (941) 748-3316
Survey Fax (941) 748-3747
E-mail: zns@manatee-cc.com
Web Page: www.manatee-cc.com/zns/

OCTOBER 30, 1997

FOXWOOD

DESCRIPTION: PARCEL, 23

A PORTION OF TRACT 45, SECTION 32, TOWNSHIP 35 SOUTH, RANGE 20 EAST, POMELLO PARK, AS PER PLAT THEREOF, RECORDED IN PLAT BOOK 6, PAGE 61 OF THE PUBLIC RECORDS OF MANATEE COUNTY, FLORIDA, BEING MORE PARTICULARLY DESCRIBED AS FOLLOWS:

FROM THE NORTHEAST CORNER OF SECTION 32, TOWNSHIP 35 SOUTH, RANGE 20 EAST, RUN S 31°53'27" W, A DISTANCE OF 2502.78 FEET TO THE POINT OF BEGINNING ALSO BEING A POINT ON THE ARC OF A CURVE TO THE LEFT WHOSE RADIUS POINT LIES S 82°00'41" E, A DISTANCE OF 525.00 FEET; THENCE SOUTHERLY ALONG THE ARC OF SAID CURVE TO THE LEFT, A DISTANCE OF 77.51 FEET THROUGH A CENTRAL ANGLE OF 08°27'31" TO THE POINT OF TANGENCY; THENCE S 00°28'12" E, A DISTANCE OF 269.88 FEET; THENCE N 89°06'10" W, A DISTANCE 635.38 FEET; THENCE N 00°28'08" W ALONG A PORTION OF THE WEST LINE OF SAID TRACT 45, A DISTANCE OF 347.24 FEET; THENCE S 89°06'10" E ALONG A PORTION OF THE NORTH LINE OF SAID TRACT 45, A DISTANCE OF 641.09 FEET TO THE POINT OF BEGINNING.

LESS AND EXCEPT A PORTION OF THE ABOVE DESCRIBED PARCEL WHICH FALLS WITHIN THE PLATTED ROAD RIGHTS OF WAY AS PER PLAT OF POMELLO PARK, RECORDED IN PLAT BOOK 6, PAGE 61 OF THE PUBLIC RECORDS OF MANATEE COUNTY, FLORIDA.

BK 1543 PG 7187 18 of 75

82



201 5th Avenue Drive East
Post Office Box 9448
Bradenton, Florida 34206

(941) 748-8080
Fax (941) 748-3316
Survey Fax (941) 748-3747
E-mail: zns@manatee-cc.com
Web Page: www.manatee-cc.com/zns/

JANUARY 21, 1998

FOXWOOD

DESCRIPTION: PARCEL 24

A PORTION OF TRACT 45, POMELLO PARK, SECTION 32, TOWNSHIP 35 SOUTH, RANGE 20 EAST, AS PER PLAT THEREOF, RECORDED IN PLAT BOOK 6, PAGE 61 OF THE PUBLIC RECORDS OF MANATEE COUNTY, FLORIDA, BEING MORE PARTICULARLY DESCRIBED AS FOLLOWS:

FROM THE NORTHEAST CORNER OF SAID SECTION 32, RUN S 28°11'30" W, A DISTANCE OF 2804.87 FEET TO THE POINT OF BEGINNING; THENCE S 00°28'12" E, A DISTANCE OF 159.98 FEET; THENCE S 89°31'48" W, A DISTANCE OF 25.00 FEET; THENCE S 00°28'12" E, A DISTANCE OF 40.00 FEET; THENCE N 89°31'48" E, A DISTANCE OF 50.00 FEET; THENCE S 00°28'12" E, A DISTANCE OF 141.47 FEET; THENCE N 89°13'20" W, A DISTANCE OF 660.36 FEET; THENCE N 00°28'08" W ALONG THE WEST LINE OF SAID TRACT 45, A DISTANCE OF 342.24 FEET; THENCE S 89°06'10" E, A DISTANCE OF 635.38 FEET TO THE POINT OF BEGINNING.

LESS AND EXCEPT ANY PORTION OF THE ABOVE DESCRIBED PARCEL WHICH FALLS WITHIN THE PLATTED ROAD RIGHTS OF WAY AS PER PLAT OF POMELLO PARK RECORDED IN PLAT BOOK 6, PAGE 61 OF THE PUBLIC RECORDS OF MANATEE COUNTY, FLORIDA.

BM 1543 PG 7188 19 of 75

04



201 5th Avenue Drive East
Post Office Box 9448
Bradenton, Florida 34206

(941) 748-8080
Fax (941) 748-3316
Survey Fax (941) 748-3747
E-mail: zns@manatee-cc.com
Web Page: www.manatee-cc.com/zns/

DECEMBER 3, 1997

FOXWOOD

DESCRIPTION: PARCEL 25

A PORTION OF TRACT 36, SECTION 32, TOWNSHIP 35 SOUTH, RANGE 20 EAST, POMELLO PARK, AS PER PLAT THEREOF, RECORDED IN PLAT BOOK 6, PAGE 61 OF THE PUBLIC RECORDS OF MANATEE COUNTY, FLORIDA, BEING MORE PARTICULARLY DESCRIBED AS FOLLOWS:

FROM THE NORTHEAST CORNER OF SECTION 32, TOWNSHIP 35 SOUTH, RANGE 20 EAST, RUN S 38°31'36" W, A DISTANCE OF 3147.30 FEET TO THE POINT OF BEGINNING; THENCE S 00°28'08" E ALONG A PORTION OF THE EAST LINE OF SAID TRACT 36, A DISTANCE OF 342.24 FEET; THENCE N 88°06'17" W, A DISTANCE OF 685.79 FEET; THENCE N 00°28'05" W, A DISTANCE OF 130.00 FEET; THENCE S 89°49'27" E, A DISTANCE OF 19.40 FEET; THENCE N 00°10'33" E, A DISTANCE OF 200.00 FEET; THENCE S 89°06'10" E, A DISTANCE OF 663.74 FEET TO THE POINT OF BEGINNING.

SUBJECT TO A 25 FOOT WIDE DRAINAGE EASEMENT ADJACENT TO THE SOUTH LINE OF THE ABOVE DESCRIBED PARCEL AND LYING WITHIN SAID PARCEL.

BY 1543 DC 7100
DA 1543 DC 7100
20 of 75

12



201 5th Avenue Drive East
Post Office Box 9448
Bradenton, Florida 34206

(941) 748-8080
Fax (941) 748-3316
Survey Fax (941) 748-3747
E-mail: zns@manatee-cc.com
Web Page: www.manatee-cc.com/zns/

NOVEMBER 20, 1997

FOXWOOD

DESCRIPTION: PARCEL 26

A PORTION OF TRACT 36, SECTION 32, TOWNSHIP 35 SOUTH, RANGE 20 EAST, POMELLO PARK AS PER PLAT THEREOF RECORDED IN PLAT BOOK 6, PAGE 61 OF THE PUBLIC RECORDS OF MANATEE COUNTY, FLORIDA, BEING MORE PARTICULARLY DESCRIBED AS FOLLOWS:

FROM THE NORTHEAST CORNER OF SAID SECTION 32, RUN N 88°44'41" W ALONG THE NORTH LINE OF SAID SECTION 32, A DISTANCE OF 2641.83 FEET TO THE WEST LINE OF THE NORTHEAST 1/4 OF SAID SECTION 32; THENCE S 00°28'05" E ALONG SAID WEST LINE, A DISTANCE OF 2162.58 FEET; THENCE N 89°31'55" E, A DISTANCE OF 0.55 FEET TO THE POINT OF BEGINNING; THENCE S 89°06'10" E ALONG THE NORTH LINE OF SAID TRACT 36, A DISTANCE OF 659.84 FEET TO THE EAST LINE OF SAID TRACT 36; THENCE S 00°28'08" E ALONG SAID EAST LINE, A DISTANCE OF 347.24 FEET; THENCE N 89°06'10" W, A DISTANCE OF 663.74 FEET; THENCE N 00°10'33" E, A DISTANCE OF 347.17 FEET TO THE POINT OF BEGINNING.

LESS AND EXCEPT THE PORTION OF THE ABOVE DESCRIBED PARCEL WHICH FALLS WITHIN THE PLATTED ROAD RIGHTS OF WAY AS PER PLAT OF POMELLO PARK, RECORDED IN PLAT BOOK 6, PAGE 61 OF THE PUBLIC RECORDS OF MANATEE COUNTY, FLORIDA.

BOOK 1543 PG 7190 21 of 75



201 5th Avenue Drive East
Post Office Box 9448
Bradenton, Florida 34206

(941) 748-8080
Fax (941) 748-3316
Survey Fax (941) 748-3747
E-mail: zns@manatee-cc.com
Web Page: www.manatee-cc.com/zns/

NOVEMBER 20, 1997

FOXWOOD

DESCRIPTION: PARCEL 27

A PORTION OF TRACT 35, SECTION 32, TOWNSHIP 35 SOUTH, RANGE 20 EAST, POMELLO PARK, AS PER PLAT THEREOF, RECORDED IN PLAT BOOK 6, PAGE 61 OF THE PUBLIC RECORDS OF MANATEE COUNTY, FLORIDA, BEING MORE PARTICULARLY DESCRIBED AS FOLLOWS:

FROM THE NORTHEAST CORNER OF SAID SECTION 32, N 88°44'41" W ALONG THE NORTH LINE OF SAID SECTION 32, A DISTANCE OF 2641.83 FEET TO THE WEST LINE OF THE NORTHEAST 1/4 OF SAID SECTION 32; THENCE S 00°28'05" E ALONG SAID WEST LINE, A DISTANCE OF 1815.44 FEET; THENCE N 89°31'55" E, A DISTANCE OF 4.45 FEET TO THE POINT OF BEGINNING; THENCE S 89°06'10" E, A DISTANCE OF 655.93 FEET TO THE EAST LINE OF SAID TRACT 35; THENCE S 00°28'08" E ALONG SAID EAST LINE, A DISTANCE OF 347.24 FEET TO THE SOUTH LINE OF SAID TRACT 35; THENCE N 89°06'10" W ALONG SAID SOUTH LINE, A DISTANCE OF 659.84 FEET; THENCE N 00°10'33" E, A DISTANCE OF 347.17 FEET TO THE POINT OF BEGINNING.

LESS AND EXCEPT ANY PORTION OF THE ABOVE DESCRIBED PARCEL WHICH FALLS WITHIN THE PLATTED ROAD RIGHTS OF WAY AS PER PLAT OF POMELLO PARK, RECORDED IN PLAT BOOK 6, PAGE 61 OF THE PUBLIC RECORDS OF MANATEE COUNTY, FLORIDA.

BK 1543 PG 7191 22 of 75

Handwritten mark or signature.



201 5th Avenue Drive East
Post Office Box 9448
Bradenton, Florida 34206

(941) 748-8080
Fax (941) 748-3316
Survey Fax (941) 748-3747
E-mail: zns@manatee-cc.com
Web Page: www.manatee-cc.com/zns/

NOVEMBER 20, 1997

FOXWOOD

DESCRIPTION: PARCEL 28

A PORTION OF TRACT 35, SECTION 32, TOWNSHIP 35 SOUTH, RANGE 20 EAST, POMELLO PARK, AS PER PLAT THEREOF, RECORDED IN PLAT BOOK 6, PAGE 61 OF THE PUBLIC RECORDS OF MANATEE COUNTY, FLORIDA, BEING MORE PARTICULARLY DESCRIBED AS FOLLOWS:

FROM THE NORTHEAST CORNER OF SAID SECTION 32, RUN N 88°44'41" W ALONG THE NORTH LINE OF SAID SECTION 32, A DISTANCE OF 2641.83 FEET TO THE WEST LINE OF THE NORTHEAST 1/4 OF SAID SECTION 32; THENCE S 00°28'05" E ALONG SAID WEST LINE, A DISTANCE OF 1466.72 FEET; THENCE S 88°59'00" E, A DISTANCE OF 79.99 FEET TO THE POINT OF BEGINNING; THENCE CONTINUE S 88°59'00" E, A DISTANCE OF 580.41 FEET TO THE EAST LINE OF SAID TRACT 35; THENCE S 00°28'08" E ALONG SAID EAST LINE, A DISTANCE OF 347.24 FEET; THENCE N 89°06'10" W, A DISTANCE OF 655.93 FEET; THENCE N 00°10'33" E, A DISTANCE OF 176.81 FEET TO THE P.C. OF A CURVE TO THE LEFT WITH A RADIUS OF 225.00 FEET; THENCE ALONG THE ARC OF SAID CURVE IN A NORTHEASTERLY DIRECTION, A DISTANCE OF 90.73 FEET THROUGH A CENTRAL ANGLE OF 23°06'12"; THENCE N 47°36'04" E, A DISTANCE OF 121.76 FEET TO THE POINT OF BEGINNING.

LESS AND EXCEPT ANY PORTION OF THE ABOVE DESCRIBED PARCEL WHICH FALLS WITHIN THE PLATTED ROAD RIGHTS OF WAY AS PER PLAT OF POMELLO PARK, RECORDED IN PLAT BOOK 6, PAGE 61 OF THE PUBLIC RECORDS OF MANATEE COUNTY, FLORIDA.

BOOK 1543 PG 7192 23 of 75

12



201 5th Avenue Drive East
Post Office Box 9448
Bradenton, Florida 34206

(941) 748-8080
Fax (941) 748-3316
Survey Fax (941) 748-3747
E-mail: zns@manatee-cc.com
Web Page: www.manatee-cc.com/zns/

NOVEMBER 20, 1997

FOXWOOD

DESCRIPTION: PARCEL 29

A PORTION OF TRACTS 30 AND 34, SECTION 32, TOWNSHIP 35 SOUTH, RANGE 20 EAST, POMELLO PARK, AS PER PLAT THEREOF, RECORDED IN PLAT BOOK 6, PAGE 61 OF THE PUBLIC RECORDS OF MANATEE COUNTY, FLORIDA, BEING MORE DESCRIBED AS FOLLOWS:

FROM THE NORTHEAST CORNER OF SAID SECTION 32, RUN N 88°44'41" W ALONG THE NORTH LINE OF SAID SECTION 32, A DISTANCE OF 2641.83 FEET TO THE WEST LINE OF THE NORTHEAST 1/4 OF SAID SECTION 32; THENCE S 00°28'05" E ALONG SAID WEST LINE, A DISTANCE OF 720.86 FEET; THENCE S 88°51'51" E, A DISTANCE OF 25.00 FEET TO THE POINT OF BEGINNING; THENCE CONTINUE S 88°51'51" E ALONG THE NORTH LINE OF SAID TRACT 34, A DISTANCE OF 635.42 FEET TO THE EAST LINE OF SAID TRACT 34; THENCE S 00°28'08" E ALONG SAID EAST LINE, A DISTANCE OF 694.47 FEET; THENCE N 88°59'00" W, A DISTANCE OF 599.82 FEET; THENCE S 47°36'04" W, A DISTANCE OF 130.19 FEET TO A POINT ON THE ARC OF A CURVE TO THE LEFT WHOSE RADIUS POINT LIES S 53°58'50" W, A DISTANCE OF 225.00 FEET; THENCE ALONG THE ARC OF SAID CURVE TO THE LEFT IN A NORTHEASTERLY DIRECTION, A DISTANCE OF 50.10 FEET THROUGH A CENTRAL ANGLE OF 12°45'31"; THENCE N 47°36'04" E, A DISTANCE OF 126.22 FEET; THENCE N 00°28'05" W, A DISTANCE OF 662.19 FEET TO THE POINT OF BEGINNING.

LESS AND EXCEPT ANY PORTION OF THE ABOVE DESCRIBED PARCEL WHICH FALLS WITHIN THE PLATTED ROAD RIGHTS OF WAY AS PER PLAT OF POMELLO PARK, RECORDED IN PLAT BOOK 6, PAGE 61 OF THE PUBLIC RECORDS OF MANATEE COUNTY, FLORIDA.

BOOK 1543 PG 7193 24 of 75



201 5th Avenue Drive East
Post Office Box 9448
Bradenton, Florida 34206

(941) 748-8080
Fax (941) 748-3316
Survey Fax (941) 748-3747
E-mail: zns@manatee-cc.com
Web Page: www.manatee-cc.com/zns/

NOVEMBER 20, 1997

FOXWOOD

DESCRIPTION: PARCEL 30

A PORTION OF TRACT 33, SECTION 32, TOWNSHIP 35 SOUTH, RANGE 20 EAST, POMELLO PARK, AS PER PLAT THEREOF, RECORDED IN PLAT BOOK 6, PAGE 61 OF THE PUBLIC RECORDS OF MANATEE COUNTY, FLORIDA, BEING MORE PARTICULARLY DESCRIBED AS FOLLOWS:

FROM THE NORTHEAST CORNER OF SAID SECTION 32, RUN N 88°44'41" W ALONG THE NORTH LINE OF SAID SECTION 32, A DISTANCE OF 1981.37 FEET; THENCE S 00°28'08" E, A DISTANCE OF 20.32 FEET TO THE POINT OF BEGINNING; THENCE CONTINUE S 00°28'08" E ALONG THE NORTHERLY EXTENSION OF THE EAST LINE OF SAID TRACT 33 AND EAST LINE OF SAID TRACT 33, A DISTANCE OF 699.17 FEET TO THE SOUTH LINE OF SAID TRACT 33; THENCE N 88°51'51" W ALONG SAID SOUTH LINE, A DISTANCE OF 635.42 FEET; THENCE N 00°28'05" W, A DISTANCE OF 695.79 FEET; THENCE S 88°44'41" E, A DISTANCE OF 124.39 FEET TO THE P.C. OF A CURVE TO THE RIGHT WITH A RADIUS OF 1275.00 FEET; THENCE ALONG THE ARC OF SAID CURVE IN AN EASTERLY DIRECTION, A DISTANCE OF 137.02 FEET THROUGH A CENTRAL ANGLE OF 06°09'27" TO A POINT OF REVERSE CURVATURE WITH A CURVE TO THE LEFT HAVING A RADIUS OF 1325.00 FEET; THENCE ALONG THE ARC OF SAID CURVE IN AN EASTERLY DIRECTION, A DISTANCE OF 343.87 FEET THROUGH A CENTRAL ANGLE OF 14°52'11" TO A POINT OF REVERSE CURVATURE OF A CURVE TO THE RIGHT WITH A RADIUS OF 1275.00 FEET; THENCE ALONG THE ARC OF SAID CURVE TO THE RIGHT IN AN EASTERLY DIRECTION, A DISTANCE OF 31.64 FEET THROUGH A CENTRAL ANGLE OF 01°25'19" TO THE POINT OF BEGINNING.

PK 1543 PG 7194 25 of 75

PK



201 5th Avenue Drive East
Post Office Box 9448
Bradenton, Florida 34206

(941) 748-8080
Fax (941) 748-3316
Survey Fax (941) 748-3747
E-mail: zns@manatee-cc.com
Web Page: www.manatee-cc.com/zns/

NOVEMBER 20, 1997

FOXWOOD

DESCRIPTION: PARCEL 31

A PORTION OF TRACT 40, SECTION 29, TOWNSHIP 35 SOUTH, RANGE 20 EAST, POMELLO PARK, AS PER PLAT THEREOF, RECORDED IN PLAT BOOK 6, PAGE 61 OF THE PUBLIC RECORDS OF MANATEE COUNTY, FLORIDA, BEING MORE PARTICULARLY DESCRIBED AS FOLLOWS:

FROM THE SOUTHEAST CORNER OF SAID SECTION 29, RUN N 87°52'46" W, A DISTANCE OF 1982.20 FEET TO THE POINT OF BEGINNING; BEING A POINT ON THE ARC OF A CURVE TO THE LEFT WHOSE RADIUS POINT BEARS S 05°48'41" E AT A DISTANCE OF 1325.00 FEET; THENCE ALONG THE ARC OF SAID CURVE TO THE LEFT, A DISTANCE OF 38.05 FEET THROUGH A CENTRAL ANGLE OF 01°38'44" TO A POINT OF REVERSE CURVATURE OF A CURVE TO THE RIGHT WITH A RADIUS OF 1275.00 FEET; THENCE ALONG THE ARC OF SAID CURVE TO THE RIGHT IN A WESTERLY DIRECTION, A DISTANCE OF 330.90 FEET THROUGH A CENTRAL ANGLE OF 14°52'11" TO A POINT OF REVERSE CURVATURE WITH A CURVE TO THE LEFT; THENCE WESTERLY ALONG ARC OF CURVE TO LEFT, A DISTANCE OF 142.40 FEET THROUGH CENTRAL ANGLE OF 06°09'27" TO THE POINT OF TANGENCY OF SAID CURVE; THENCE N 88°44'41" W, A DISTANCE OF 125.71 FEET; THENCE N 00°02'46" W, A DISTANCE OF 451.37 FEET TO THE POINT OF CURVATURE OF A CURVE TO THE LEFT WITH A RADIUS OF 225.00 FEET; THENCE ALONG THE ARC OF SAID CURVE TO THE LEFT IN A NORTHERLY DIRECTION, A DISTANCE OF 28.87 FEET THROUGH A CENTRAL ANGLE OF 07°21'10"; THENCE S 88°44'41" E, A DISTANCE OF 638.56 FEET TO THE EAST LINE OF SAID TRACT 40; THENCE S 00°05'48" W ALONG SAID EAST LINE, A DISTANCE OF 475.16 FEET TO THE POINT OF BEGINNING.

LESS AND EXCEPT ANY PORTION OF THE ABOVE DESCRIBED PARCEL WHICH FALLS WITHIN THE PLATTED ROAD RIGHTS OF WAY AS PER PLAT OF POMELLO PARK, RECORDED IN PLAT BOOK 6, PAGE 61 OF THE PUBLIC RECORDS OF MANATEE COUNTY, FLORIDA.

DK 1543 PG 7195 26 of 75



201 5th Avenue Drive East
Post Office Box 9448
Bradenton, Florida 34206

(941) 748-8080
Fax (941) 748-3316
Survey Fax (941) 748-3747
E-mail: zns@manatee-cc.com
Web Page: www.manatee-cc.com/zns/

NOVEMBER 20, 1997

FOXWOOD

DESCRIPTION: PARCEL 32

A PORTION OF TRACTS 25, 26, 39 AND 40, SECTION 29, TOWNSHIP 35 SOUTH, RANGE 20 EAST, POMELLO PARK, AS PER PLAT THEREOF, RECORDED IN PLAT BOOK 6, PAGE 61 OF THE PUBLIC RECORDS OF MANATEE COUNTY, FLORIDA, BEING MORE PARTICULARLY DESCRIBED AS FOLLOWS:

FROM THE SOUTHEAST CORNER OF SAID SECTION 29, RUN N 74°30'59" W, A DISTANCE OF 2054.61 FEET TO THE POINT OF BEGINNING; THENCE N 88°44'41" W, A DISTANCE OF 638.56 FEET TO THE POINT ON THE ARC OF THE CURVE TO THE LEFT WHOSE RADIUS POINT BEARS S 82°36'04" W, A DISTANCE OF 225.00; THENCE ALONG THE ARC OF SAID CURVE TO THE LEFT IN A NORTHWESTERLY DIRECTION, A DISTANCE OF 200.00 FEET THROUGH A CENTRAL ANGLE OF 50°55'46"; THENCE N 14°21'43" E, A DISTANCE OF 328.38 FEET; THENCE S 88°44'41" E, A DISTANCE OF 662.92 FEET TO THE EAST LINE OF SAID TRACT 39; THENCE S 00°05'48" W ALONG SAID EAST LINE AND THE EAST LINE OF SAID TRACT 40, A DISTANCE OF 480.10 FEET TO THE POINT OF BEGINNING.

LESS AND EXCEPT ANY PORTION OF THE ABOVE DESCRIBED PARCEL WHICH FALLS WITHIN THE PLATTED RIGHTS OF WAY AS PER PLAT OF POMELLO PARK, RECORDED IN PLAT BOOK 6, PAGE 61 OF THE PUBLIC RECORDS OF MANATEE COUNTY, FLORIDA.

BK 1543 PG 7196 27 of 75

R



201 5th Avenue Drive East
Post Office Box 9448
Bradenton, Florida 34206

(941) 748-8080
Fax (941) 748-3316
Survey Fax (941) 748-3747
E-mail: zns@manatee-cc.com
Web Page: www.manatee-cc.com/zns/

JANUARY 13, 1998

FOXWOOD

DESCRIPTION: PARCEL 33

A PORTION OF TRACTS 26 AND 27, POMELLO PARK, SECTION 29, TOWNSHIP 35 SOUTH, RANGE 20 EAST, AS PER PLAT THEREOF, RECORDED IN PLAT BOOK 6, PAGE 61 OF THE PUBLIC RECORDS OF MANATEE COUNTY, FLORIDA, BEING MORE PARTICULARLY DESCRIBED AS FOLLOWS:

FROM THE SOUTHWEST CORNER OF SAID SECTION 29, RUN N 72°40'58" E, A DISTANCE OF 2072.67 FEET TO THE POINT OF BEGINNING; THENCE N 00°11'22" W ALONG A PORTION OF THE WEST LINE OF SAID TRACT 26 AND SAID TRACT 27, A DISTANCE OF 1253.65 FEET; THENCE S 69°03'35" E ALONG THE SOUTHERLY RIGHT OF WAY LINE OF THE FORMER EAST AND WEST COAST RAILROAD, A DISTANCE OF 712.32 FEET; THENCE S 00°02'46" E, A DISTANCE OF 688.64 FEET; THENCE S 14°21'43" W, A DISTANCE OF 328.38 FEET TO A POINT ON THE ARC OF A CURVE TO THE LEFT WHOSE RADIUS POINT LIES S 31°40'18" W, A DISTANCE OF 225.00 FEET; THENCE WESTERLY ALONG THE ARC OF SAID CURVE TO THE LEFT, A DISTANCE OF 44.88 FEET THROUGH A CENTRAL ANGLE OF 11°25'39"; THENCE N 20°13'16" E, A DISTANCE OF 25.00 FEET; THENCE N 69°46'44" W, A DISTANCE OF 40.00 FEET; THENCE S 20°13'16" W, A DISTANCE OF 63.77 FEET; THENCE N 88°45'15" W ALONG A PORTION OF THE SOUTH LINE OF SAID TRACT 26, A DISTANCE OF 489.13 FEET TO THE POINT OF BEGINNING.

LESS AND EXCEPT ANY PORTION OF THE ABOVE DESCRIBED PARCEL WHICH FALLS WITHIN THE PLATTED ROAD RIGHTS OF WAY AS PER PLAT OF POMELLO PARK RECORDED IN PLAT BOOK 6, PAGE 61 OF THE PUBLIC RECORDS OF MANATEE COUNTY, FLORIDA.

BK 1543 PG 7197 28 of 75

PL



201 5th Avenue Drive East
Post Office Box 9448
Bradenton, Florida 34206

(941) 748-8080
Fax (941) 748-3316
Survey Fax (941) 748-3747
E-mail: zns@manatee-cc.com
Web Page: www.manatee-cc.com/zns/

NOVEMBER 20, 1997

FOXWOOD

DESCRIPTION: PARCEL 34

A PORTION OF TRACT 25, SECTION 29, TOWNSHIP 35 SOUTH, RANGE 20 EAST, POMELLO PARK, AS PER PLAT THEREOF, RECORDED IN PLAT BOOK 6, PAGE 61 OF THE PUBLIC RECORDS OF MANATEE COUNTY, FLORIDA, BEING MORE PARTICULARLY DESCRIBED AS FOLLOWS:

FROM THE SOUTHEAST CORNER OF SAID SECTION 29, RUN N 88°44'41" W ALONG THE SOUTH LINE OF SAID SECTION 29, A DISTANCE OF 2667.40 FEET; THENCE N 01°15'19" E, A DISTANCE OF 25.00 FEET TO THE POINT OF BEGINNING; THENCE N 88°44'41" W, A DISTANCE OF 93.25 FEET TO THE POINT OF CURVATURE OF A CURVE TO THE RIGHT WITH A RADIUS OF 1275.00 FEET; THENCE ALONG THE ARC OF SAID CURVE TO THE RIGHT IN A WESTERLY DIRECTION, A DISTANCE OF 137.02 FEET THROUGH A CENTRAL ANGLE OF 06°09'27" TO A POINT OF REVERSE CURVATURE OF A CURVE TO THE LEFT WITH A RADIUS OF 1325.00 FEET; THENCE ALONG THE ARC OF SAID CURVE TO THE LEFT IN A WESTERLY DIRECTION, A DISTANCE OF 343.87 FEET THROUGH A CENTRAL ANGLE OF 14°52'11" TO A POINT OF REVERSE CURVATURE OF A CURVE TO THE RIGHT WITH A RADIUS OF 1275.00 FEET; THENCE ALONG THE ARC OF SAID CURVE TO THE RIGHT, A DISTANCE OF 62.98 FEET THROUGH A CENTRAL ANGLE OF 02°49'49"; THENCE N 00°11'22" W ALONG THE SOUTHERLY EXTENSION OF THE WEST LINE OF SAID TRACT 25 AND THE WEST LINE OF SAID TRACT 25, A DISTANCE OF 643.65 FEET TO THE NORTH LINE OF SAID TRACT 25; THENCE SOUTH 88°45'15" E ALONG SAID NORTH LINE, A DISTANCE OF 489.13 FEET; THENCE S 20°13'16" W, A DISTANCE OF 36.23 FEET; THENCE S 69°46'44" E, A DISTANCE OF 40.00 FEET; THENCE N 20°13'16" E, A DISTANCE OF 25.00 FEET TO A POINT ON THE ARC OF A CURVE TO THE RIGHT WHOSE RADIUS POINT LIES S 20°15'03" W, A DISTANCE OF 175.00 FEET; THENCE ALONG THE ARC OF SAID CURVE TO THE RIGHT IN A SOUTHEASTERLY DIRECTION, A DISTANCE OF 212.90 FEET THROUGH A CENTRAL ANGLE OF 69°42'11" TO THE P.T. OF SAID CURVE; THENCE S 00°02'46" E, A DISTANCE OF 450.24 FEET TO THE POINT OF BEGINNING.

LESS AND EXCEPT ANY PORTION OF THE ABOVE DESCRIBED PARCEL WHICH FALLS WITHIN THE PLATTED ROAD RIGHTS OF WAY AS PER PLAT OF POMELLO PARK, RECORDED IN PLAT BOOK 6, PAGE 61 OF THE PUBLIC RECORDS OF MANATEE COUNTY, FLORIDA.

BK 1543 PG 7198 29 of 75

ke



201 5th Avenue Drive East
Post Office Box 9448
Bradenton, Florida 34206

(941) 748-8080
Fax (941) 748-3316
Survey Fax (941) 748-3747
E-mail: zns@manatee-cc.com
Web Page: www.manatee-cc.com/zns/

DECEMBER 22, 1997

FOXWOOD

DESCRIPTION: PARCEL 35

A PORTION OF TRACT 17 AND 32, SECTION 32, TOWNSHIP 35 SOUTH, RANGE 20 EAST, POMELLO PARK, AS PER PLAT THEREOF, RECORDED IN PLAT BOOK 6, PAGE 61 OF THE PUBLIC RECORDS OF MANATEE COUNTY, FLORIDA, BEING MORE PARTICULARLY DESCRIBED AS FOLLOWS:

FROM THE NORTHEAST CORNER OF SECTION 32, TOWNSHIP 35 SOUTH, RANGE 20 EAST, RUN N 89°16'55" W, A DISTANCE OF 2666.21 FEET TO THE POINT OF BEGINNING; THENCE S 00°28'05" E, A DISTANCE OF 695.90 FEET; THENCE N 88°51'51" W ALONG THE SOUTH LINE OF SAID TRACT 32 AND SAID TRACT 17, A DISTANCE OF 954.42 FEET; THENCE N 00°27'58" W, A DISTANCE OF 694.58 FEET TO A POINT ON THE ARC OF A CURVE TO THE RIGHT WHOSE RADIUS POINT LIES S 05°23'04" W, A DISTANCE OF 1275.00 FEET; THENCE EASTERLY ALONG THE ARC OF SAID CURVE TO THE RIGHT, A DISTANCE OF 45.14 FEET THROUGH A CENTRAL ANGLE OF 02°01'42" TO A POINT OF REVERSE CURVATURE WITH A CURVE TO THE LEFT HAVING A RADIUS OF 1325.00 FEET; THENCE EASTERLY ALONG THE ARC OF SAID CURVE TO THE LEFT, A DISTANCE OF 343.87 FEET THROUGH A CENTRAL ANGLE OF 14°52'11" TO A POINT OF REVERSE CURVATURE WITH A CURVE TO THE RIGHT HAVING A RADIUS OF 1275.00 FEET; THENCE EASTERLY ALONG THE ARC OF SAID CURVE TO THE RIGHT, A DISTANCE OF 330.90 FEET THROUGH A CENTRAL ANGLE OF 14°52'11" TO A POINT OF REVERSE CURVATURE WITH A CURVE TO THE LEFT HAVING A RADIUS OF 1325.00 FEET; THENCE EASTERLY ALONG THE ARC OF SAID CURVE TO THE LEFT, A DISTANCE OF 142.40 FEET THROUGH A CENTRAL ANGLE OF 06°09'27" TO THE POINT OF TANGENCY; THENCE S 88°44'41" E, A DISTANCE OF 94.57 FEET TO THE POINT OF BEGINNING.

LESS AND EXCEPT ANY PORTION OF THE ABOVE DESCRIBED PARCEL WHICH FALLS WITHIN THE PLATTED ROAD RIGHTS OF WAY AS PER PLAT OF POMELLO PARK RECORDED IN PLAT BOOK 6, PAGE 61 OF THE PUBLIC RECORDS OF MANATEE COUNTY, FLORIDA.

BK 1543 PG 7199 30 OF 75



201 5th Avenue Drive East
Post Office Box 9448
Bradenton, Florida 34206

(941) 748-8080
Fax (941) 748-3316
Survey Fax (941) 748-3747
E-mail: zns@manatee-cc.com
Web Page: www.manatee-cc.com/zns/

DECEMBER 2, 1997

FOXWOOD

DESCRIPTION: PARCEL 36

A PORTION OF TRACT 31, SECTION 32, TOWNSHIP 35 SOUTH, RANGE 20 EAST, POMELLO PARK, AS PER PLAT THEREOF, RECORDED IN PLAT BOOK 6, PAGE 61 OF THE PUBLIC RECORDS OF MANATEE COUNTY, FLORIDA, BEING MORE PARTICULARLY DESCRIBED AS FOLLOWS:

FROM THE NORTHEAST CORNER OF SECTION 32, TOWNSHIP 35 SOUTH, RANGE 20 EAST, RUN S 76°01'00" W, A DISTANCE OF 2741.55 FEET; THENCE N 88°51'51" W, A DISTANCE OF 317.71 FEET TO THE POINT OF BEGINNING; THENCE S 00°28'05" E, A DISTANCE OF 696.56 FEET; THENCE N 88°59'00" W, A DISTANCE OF 317.71 FEET; THENCE N 00°28'01" W ALONG THE WEST LINE OF SAID TRACT 31, A DISTANCE OF 697.22 FEET; THENCE S 88°51'51" E ALONG THE NORTH LINE OF SAID TRACT 31, A DISTANCE OF 317.71 FEET TO THE POINT OF BEGINNING.

BOOK 1543 PG 7200 31 of 75



201 5th Avenue Drive East
Post Office Box 9448
Bradenton, Florida 34206

(941) 748-8080
Fax (941) 748-3316
Survey Fax (941) 748-3747
E-mail: zns@manatee-cc.com
Web Page: www.manatee-cc.com/zns/

DECEMBER 4, 1997

FOXWOOD

DESCRIPTION: PARCEL 36A

A PORTION OF TRACT 31, SECTION 32, TOWNSHIP 35 SOUTH, RANGE 20 EAST, POMELLO PARK, AS PER PLAT THEREOF, RECORDED IN PLAT BOOK 6, PAGE 61 OF THE PUBLIC RECORDS OF MANATEE COUNTY, FLORIDA, BEING MORE PARTICULARLY DESCRIBED AS FOLLOWS:

FROM THE NORTHEAST CORNER OF SECTION 32, TOWNSHIP 35 SOUTH, RANGE 20 EAST, RUN S 76°01'00" W, A DISTANCE OF 2741.55 FEET TO THE POINT OF BEGINNING; THENCE S 00°28'05" E, A DISTANCE OF 641.29 FEET; THENCE S 47°36'04" W, A DISTANCE OF 115.40 FEET TO A POINT ON THE ARC OF A CURVE TO THE LEFT WHOSE RADIUS POINT LIES S 28°07'48" W, A DISTANCE OF 225.00 FEET; THENCE WESTERLY ALONG THE ARC OF SAID CURVE TO THE LEFT, A DISTANCE OF 106.47 FEET THROUGH A CENTRAL ANGLE OF 27°06'48" TO THE POINT OF TANGENCY; THENCE N 88°59'00" W, A DISTANCE OF 129.91 FEET; THENCE N 00°28'05" W, A DISTANCE OF 696.56 FEET; THENCE S 88°51'51" E, A DISTANCE OF 317.71 FEET TO THE POINT OF BEGINNING.

LESS AND EXCEPT ANY PORTION OF THE ABOVE DESCRIBED PARCEL WHICH FALLS WITHIN THE PLATTED ROAD RIGHTS OF WAY AS PER PLAT OF POMELLO PARK RECORDED IN PLAT BOOK 6, PAGE 61 OF THE PUBLIC RECORDS OF MANATEE COUNTY, FLORIDA.

BN 1543 PG 7201 32 of 75



201 5th Avenue Drive East
Post Office Box 9448
Bradenton, Florida 34206

(941) 748-8080
Fax (941) 748-3316
Survey Fax (941) 748-3747
E-mail: zns@manatee-cc.com
Web Page: www.manatee-cc.com/zns/

NOVEMBER 20, 1997

FOXWOOD

DESCRIPTION: PARCEL 37

A PORTION OF TRACTS 29 AND 30, SECTION 32, TOWNSHIP 35 SOUTH, RANGE 20 EAST, POMELLO PARK, AS PER PLAT THEREOF, RECORDED IN PLAT BOOK 6, PAGE 61 OF THE PUBLIC RECORDS OF MANATEE COUNTY, FLORIDA; BEING MORE PARTICULARLY DESCRIBED AS FOLLOWS:

FROM THE NORTHEAST CORNER OF SAID SECTION 32, RUN S 50°40'27" W, A DISTANCE OF 3455.79 FEET TO THE POINT OF BEGINNING; THENCE N 89°49'27" W, A DISTANCE OF 398.10 FEET; THENCE N 00°27'58" W, A DISTANCE OF 788.01 FEET; THENCE S 88°59'00" E, A DISTANCE OF 234.52 FEET TO THE POINT OF CURVATURE OF A CURVE TO THE RIGHT WITH A RADIUS OF 175.00 FEET; THENCE ALONG THE ARC OF SAID CURVE TO THE RIGHT IN A SOUTHEASTERLY DIRECTION, A DISTANCE OF 272.32 FEET THROUGH A CENTRAL ANGLE OF 89°09'33" TO THE POINT OF TANGENCY OF SAID CURVE; THENCE S 00°10'33" W, A DISTANCE OF 609.53 FEET TO THE POINT OF BEGINNING.

BN 1543 PG 7202 33 of 75

PK



201 5th Avenue Drive East
Post Office Box 9448
Bradenton, Florida 34206

(941) 748-8080
Fax (941) 748-3316
Survey Fax (941) 748-3747
E-mail: zns@manatee-cc.com
Web Page: www.manatee-cc.com/zns/

December 3, 1997

FOXWOOD

DESCRIPTION: PARCEL 38

A PORTION OF TRACT 20 AND TRACT 29, SECTION 32, TOWNSHIP 35 SOUTH, RANGE 20 EAST, POMELLO PARK, AS PER PLAT THEREOF, RECORDED IN PLAT BOOK 6, PAGE 61 OF THE PUBLIC RECORDS OF MANATEE COUNTY, FLORIDA, BEING MORE PARTICULARLY DESCRIBED AS FOLLOWS:

FROM THE NORTHEAST CORNER OF SECTION 32, TOWNSHIP 35 SOUTH, RANGE 20 EAST, RUN S 50°40'27" W, A DISTANCE OF 3455.79 FEET TO THE POINT OF BEGINNING; THENCE S 00°10'33" W, A DISTANCE OF 406.60 FEET; THENCE N 89°49'27" W, A DISTANCE OF 20.00 FEET; THENCE S 00°10'33" W, A DISTANCE OF 25.00 FEET; THENCE S 89°49'27" E, A DISTANCE OF 20.00 FEET; THENCE S 00°10'33" W, A DISTANCE OF 30.00 FEET; THENCE S 89°49'27" E, A DISTANCE OF 30.60 FEET; THENCE S 00°28'05" E, A DISTANCE OF 130.00 FEET; THENCE N 68°04'19" W, A DISTANCE OF 458.05 FEET; THENCE N 60°40'31" W, A DISTANCE OF 452.95 FEET; THENCE N 00°27'58" W, A DISTANCE OF 265.84 FEET; THENCE S 89°49'27" E, A DISTANCE OF 821.58 FEET TO THE POINT OF BEGINNING.

SUBJECT TO A 25 FOOT DRAINAGE EASEMENT LYING ADJACENT TO THE SOUTHWESTERLY BOUNDARY OF THE ABOVE DESCRIBED PARCEL AND LYING WITHIN SAID PARCEL.

BK 1543 PG 7203 34 of 75

12



201 5th Avenue Drive East
Post Office Box 9448
Bradenton, Florida 34206

(941) 748-8080
Fax (941) 748-3316
Survey Fax (941) 748-3747
E-mail: zns@manatee-cc.com
Web Page: www.manatee-cc.com/zns/

DECEMBER 2, 1997

FOXWOOD

DESCRIPTION: PARCEL 39

A PORTION OF TRACTS 19, 20, 29 AND 30, SECTION 32, TOWNSHIP 35 SOUTH, RANGE 20 EAST, POMELLO PARK AS PER PLAT THEREOF, RECORDED IN PLAT BOOK 6, PAGE 61 OF THE PUBLIC RECORDS OF MANATEE COUNTY, FLORIDA, BEING MORE PARTICULARLY DESCRIBED AS FOLLOWS:

FROM THE NORTHEAST CORNER OF SECTION 32, TOWNSHIP 35 SOUTH, RANGE 20 EAST, RUN S 65°31'38" W, A DISTANCE OF 3381.55 FEET TO THE POINT OF BEGINNING; THENCE S 00°27'58" E, A DISTANCE OF 788.01 FEET; THENCE N 89°49'27" W, A DISTANCE OF 423.48 FEET; THENCE N 00°27'58" W, A DISTANCE OF 794.22 FEET; THENCE S 88°59'00" E, A DISTANCE OF 423.60 FEET TO THE POINT OF BEGINNING.

BK 1543 PG 7204 35 of 75

PL



201 5th Avenue Drive East
Post Office Box 9448
Bradenton, Florida 34206

(941) 748-8080
Fax (941) 748-3316
Survey Fax (941) 748-3747
E-mail: zns@manatee-cc.com
Web Page: www.manatee-cc.com/zns/

DECEMBER 12, 1997

FOXWOOD

DESCRIPTION: PARCEL 40

A PORTION OF TRACTS 19 AND 20, SECTION 32, TOWNSHIP 35, RANGE 20 EAST, POMELLO PARK, AS PER PLAT THEREOF, RECORDED IN PLAT BOOK 6, PAGE 61 OF THE PUBLIC RECORDS OF MANATEE COUNTY, FLORIDA, BEING MORE PARTICULARLY DESCRIBED AS FOLLOWS:

FROM THE NORTHWEST CORNER OF SECTION 32, TOWNSHIP 35 SOUTH, RANGE 20 EAST, RUN S 42°07'02" E, A DISTANCE OF 2024.27 FEET TO THE POINT OF BEGINNING; THENCE S 88°59'00" E, A DISTANCE OF 423.60 FEET; THENCE S 00°27'58" E, A DISTANCE OF 1060.06 FEET; THENCE N 73°33'44" W, A DISTANCE OF 442.58 FEET; THENCE N 00°27'58" W, A DISTANCE OF 942.33 FEET TO THE POINT OF BEGINNING.

SUBJECT TO A 25 FOOT DRAINAGE EASEMENT ADJACENT TO THE SOUTHERLY BOUNDARY OF THE ABOVE DESCRIBED PARCEL AND LYING WITHIN SAID PARCEL.

BK 1543 PG 7205 36 of 75

12



201 5th Avenue Drive East
Post Office Box 9448
Bradenton, Florida 34206

(941) 748-8080
Fax (941) 748-3316
Survey Fax (941) 748-3747
E-mail: zns@manatee-cc.com
Web Page: www.manatee-cc.com/zns/

DECEMBER 3, 1997

FOXWOOD

DESCRIPTION: PARCEL 41

A PORTION OF TRACT 18, SECTION 32, TOWNSHIP 35 SOUTH, RANGE 20 EAST, POMELLO PARK, AS PER PLAT THEREOF, RECORDED IN PLAT BOOK 6, PAGE 61 OF THE PUBLIC RECORDS, BEING MORE PARTICULARLY DESCRIBED AS FOLLOWS:

FROM THE NORTHEAST CORNER OF SECTION 32, TOWNSHIP 35 SOUTH, RANGE 20 EAST, RUN S 79°54'17" W, A DISTANCE OF 3671.39 FEET TO THE POINT OF BEGINNING; THENCE S 00°27'58" E, A DISTANCE OF 697.89 FEET; THENCE N 88°59'00" W, A DISTANCE OF 316.40 FEET; THENCE N 00°27'58" W, A DISTANCE OF 698.55 FEET; THENCE S 88°51'51" E, A DISTANCE OF 316.42 FEET TO THE POINT OF BEGINNING.

BK 1543 PG 7206 37 of 75



201 5th Avenue Drive East
Post Office Box 9448
Bradenton, Florida 34206

(941) 748-8080
Fax (941) 748-3316
Survey Fax (941) 748-3747
E-mail: zns@manatee-cc.com
Web Page: www.manatee-cc.com/zns/

December 3, 1997

FOXWOOD

DESCRIPTION: PARCEL 41A

A PORTION OF TRACT 18, SECTION 32, TOWNSHIP 35 SOUTH, RANGE 20 EAST, POMELLO PARK, AS PER PLAT THEREOF, RECORDED IN PLAT BOOK 6, PAGE 61 OF THE PUBLIC RECORDS OF MANATEE COUNTY, FLORIDA, BEING MORE PARTICULARLY DESCRIBED AS FOLLOWS:

FROM THE NORTHEAST CORNER OF SECTION 32, TOWNSHIP 35 SOUTH, RANGE 20 EAST, RUN S 78°50'42" W, A DISTANCE OF 3359.07 FEET; THENCE S 00°28'01" E ALONG THE EAST LINE OF SAID TRACT 18, A DISTANCE OF 697.22 FEET; THENCE N 88°59'00" W, A DISTANCE OF 318.99 FEET; THENCE N 00°27'58" W, A DISTANCE OF 697.89 FEET; THENCE S 88°51'51" E, A DISTANCE OF 319.00 FEET TO THE POINT OF BEGINNING.

BK 1543 PG 7207 38 of 75

12



201 5th Avenue Drive East
Post Office Box 9448
Bradenton, Florida 34206

(941) 748-8080
Fax (941) 748-3316
Survey Fax (941) 748-3747
E-mail: zns@manatee-cc.com
Web Page: www.manatee-cc.com/zns/

DECEMBER 3, 1997

FOXWOOD

DESCRIPTION: PARCEL 42

A PORTION OF TRACT 17, SECTION 32, TOWNSHIP 35 SOUTH, RANGE 20 EAST, POMELLO PARK, AS PER PLAT THEREOF, RECORDED IN PLAT BOOK 6, PAGE 61 OF THE PUBLIC RECORDS OF MANATEE COUNTY, FLORIDA, BEING MORE PARTICULARLY DESCRIBED AS FOLLOWS:

FROM THE NORTHEAST CORNER OF SECTION 32, TOWNSHIP 35 SOUTH, RANGE 20 EAST, RUN N 89°11'34" W, A DISTANCE OF 3620.55 FEET TO THE POINT OF BEGINNING; THENCE S 00°27'58" E, A DISTANCE OF 694.58 FEET; THENCE N 88°51'51" W ALONG THE SOUTH LINE OF SAID TRACT 17, A DISTANCE OF 316.46 FEET; THENCE N 00°27'58" W, A DISTANCE OF 698.55 FEET; THENCE S 88°44'41" E, A DISTANCE OF 224.73 FEET TO THE POINT OF CURVATURE OF A CURVE TO THE RIGHT HAVING A RADIUS OF 1275.00 FEET; THENCE WESTERLY ALONG THE ARC OF SAID CURVE TO THE RIGHT, A DISTANCE OF 91.88 FEET THROUGH A CENTRAL ANGLE OF 04°07'45" TO THE POINT OF BEGINNING.

BK 1543 PG 7208 39 of 75



201 5th Avenue Drive East
Post Office Box 9448
Bradenton, Florida 34206

(941) 748-8080
Fax (941) 748-3316
Survey Fax (941) 748-3747
E-mail: zns@manatee-cc.com
Web Page: www.manatee-cc.com/zns/

DECEMBER 2, 1997

FOXWOOD

DESCRIPTION: PARCEL 43

A PORTION OF TRACT 24, SECTION 29, TOWNSHIP 35 SOUTH, RANGE 20 EAST, POMELLO PARK, AS PER PLAT THEREOF, RECORDED IN PLAT BOOK 6, PAGE 61 OF THE PUBLIC RECORDS OF MANATEE COUNTY, FLORIDA, BEING MORE PARTICULARLY DESCRIBED AS FOLLOWS:

FROM THE SOUTHWEST CORNER OF SECTION 29, TOWNSHIP 35 SOUTH, RANGE 20 EAST, RUN S 89°48'34" E, A DISTANCE OF 1345.47 FEET TO THE POINT OF BEGINNING; THENCE N 00°19'57" W, A DISTANCE OF 635.30 FEET; THENCE S 88°45'15" E ALONG THE NORTH LINE OF SAID TRACT 24, A DISTANCE OF 637.10 FEET; THENCE S 00°11'22" E ALONG THE EAST LINE OF SAID TRACT 24, A DISTANCE OF 643.65 FEET TO A POINT ON THE ARC OF A CURVE TO THE RIGHT WHOSE RADIUS POINT LIES N 04°37'36" W, A DISTANCE OF 1275.00 FEET; THENCE WESTERLY ALONG THE ARC OF SAID CURVE TO THE RIGHT, A DISTANCE OF 267.91 FEET THROUGH A CENTRAL ANGLE OF 12°02'22" TO A POINT OF REVERSE CURVATURE WITH A CURVE TO THE LEFT HAVING A RADIUS OF 1325.00 FEET; THENCE WESTERLY ALONG THE ARC OF SAID CURVE TO THE LEFT, A DISTANCE OF 142.40 FEET THROUGH A CENTRAL ANGLE OF 06°09'27" TO THE POINT OF TANGENCY; THENCE N 88°44'41" W, A DISTANCE OF 226.18 FEET TO THE POINT OF BEGINNING.

LESS AND EXCEPT ANY PORTION OF THE ABOVE DESCRIBED PARCEL WHICH FALLS WITHIN THE PLATTED ROAD RIGHTS OF WAY AS PER PLAT OF POMELLO PARK RECORDED IN PLAT BOOK 6, PAGE 61 OF THE PUBLIC RECORDS OF MANATEE COUNTY, FLORIDA.

BK 1543 PG 7209 40 of 75

[Handwritten signature]



201 5th Avenue Drive East
Post Office Box 9448
Bradenton, Florida 34206

(941) 748-8080
Fax (941) 748-3316
Survey Fax (941) 748-3747
E-mail: zns@manatee-cc.com
Web Page: www.manatee-cc.com/zns/

NOVEMBER 26, 1997

FOXWOOD

DESCRIPTION: PARCEL 44

A PORTION OF TRACTS 22 AND 23, SECTION 29, TOWNSHIP 35 SOUTH, RANGE 20 EAST, POMELLO PARK, AS PER PLAT THEREOF, RECORDED IN PLAT BOOK 6, PAGE 61 OF THE PUBLIC RECORDS OF MANATEE COUNTY, FLORIDA, BEING MORE PARTICULARLY DESCRIBED AS FOLLOWS:

FROM THE SOUTHEAST CORNER OF SECTION 29, TOWNSHIP 35 SOUTH, RANGE 20 EAST, RUN N 77°29'42" W, A DISTANCE OF 3383.95 FEET TO THE POINT OF BEGINNING; THENCE N 88°45'15" W ALONG A PORTION OF THE SOUTH LINE OF SAID TRACT 23, A DISTANCE OF 612.09 FEET; THENCE N 00°19'57" W, A DISTANCE OF 40.02 FEET; THENCE N 88°45'15" W, A DISTANCE OF 50.02 FEET; THENCE N 00°19'57" W, A DISTANCE OF 1075.71 FEET; THENCE S 75°45'00" E, A DISTANCE OF 686.38 FEET; THENCE S 00°11'22" E ALONG A PORTION OF THE EAST LINE OF SAID TRACT 22 AND SAID TRACT 23, A DISTANCE OF 961.12 FEET TO THE POINT OF BEGINNING.

LESS AND EXCEPT ANY PORTION OF THE ABOVE DESCRIBED PARCEL WHICH FALLS WITHIN THE PLATTED ROAD RIGHTS OF WAY AS PER PLAT OF POMELLO PARK RECORDED IN PLAT BOOK 6, PAGE 61 OF THE PUBLIC RECORDS OF MANATEE COUNTY, FLORIDA.

BK 1543 PG 7210 41 of 75

fr



201 5th Avenue Drive East
Post Office Box 9448
Bradenton, Florida 34206

(941) 748-8080
Fax (941) 748-3316
Survey Fax (941) 748-3747
E-mail: zns@manatee-cc.com
Web Page: www.manatee-cc.com/zns/

DECEMBER 2, 1997

FOXWOOD

DESCRIPTION: PARCEL 45

A PORTION OF TRACTS 5, 6, 11, 12, 21 AND 22, SECTION 29, TOWNSHIP 35 SOUTH, RANGE 20 EAST, POMELLO PARK, AS PER PLAT THEREOF, RECORDED IN PLAT BOOK 6, PAGE 61 OF THE PUBLIC RECORDS OF MANATEE COUNTY, FLORIDA, BEING MORE PARTICULARLY DESCRIBED AS FOLLOWS:

FROM THE SOUTHEAST CORNER OF SECTION 29, TOWNSHIP 35 SOUTH, RANGE 20 EAST, RUN N 62°52'40" W, A DISTANCE OF 3715.41 FEET TO THE POINT OF BEGINNING; THENCE N 75°45'00" W, A DISTANCE OF 1401.65 FEET; THENCE N 14°15'00" E, A DISTANCE OF 49.18 FEET; THENCE N 75°45'00" W, A DISTANCE OF 40.00 FEET; THENCE S 14°15'00" W, A DISTANCE OF 25.00 FEET; THENCE N 75°45'00" W, A DISTANCE OF 160.00 FEET; THENCE N 00°37'00" W, A DISTANCE OF 468.20 FEET; THENCE S 69°03'35" E, A DISTANCE OF 1660.14 FEET; THENCE S 00°11'22" E ALONG A PORTION OF THE EAST LINE OF SAID TRACT 22, A DISTANCE OF 292.53 FEET TO THE POINT OF BEGINNING.

LESS AND EXCEPT ANY PORTION OF THE ABOVE DESCRIBED PARCEL WHICH FALLS WITHIN THE PLATTED ROAD RIGHTS OF WAY AS PER PLAT OF POMELLO PARK RECORDED IN PLAT BOOK 6, PAGE 61 OF THE PUBLIC RECORDS OF MANATEE COUNTY, FLORIDA.

BK 1543 PG 7211 42 of 75

R



201 5th Avenue Drive East
Post Office Box 9448
Bradenton, Florida 34206

(941) 748-8080
Fax (941) 748-3316
Survey Fax (941) 748-3747
E-mail: zns@manatee-cc.com
Web Page: www.manatee-cc.com/zns/

NOVEMBER 26, 1997

FOXWOOD

DESCRIPTION: PARCEL 46

A PORTION OF TRACT 5, SECTION 29, TOWNSHIP 35 SOUTH, RANGE 20 EAST, POMELLO PARK, AS PER PLAT THEREOF, RECORDED IN PLAT BOOK 6, PAGE 61 OF THE PUBLIC RECORDS OF MANATEE COUNTY, FLORIDA, BEING MORE PARTICULARLY DESCRIBED AS FOLLOWS:

FROM THE SOUTHWEST CORNER OF SECTION 29, TOWNSHIP 35 SOUTH, RANGE 20 EAST, RUN N 01°11'21" W, A DISTANCE OF 2006.34 FEET TO THE POINT OF BEGINNING; THENCE N 00°37'08" W, A DISTANCE OF 622.62 FEET; THENCE S 69°03'35" E, A DISTANCE OF 457.69 FEET; THENCE S 00°37'00" E, A DISTANCE OF 468.20 FEET; THENCE N 88°46'00" W, A DISTANCE OF 425.87 FEET TO THE POINT OF BEGINNING.

BK 1543 PG 7212 43 of 75

PE



201 5th Avenue Drive East
Post Office Box 9448
Bradenton, Florida 34206

(941) 748-8080
Fax (941) 748-3316
Survey Fax (941) 748-3747
E-mail: zns@manatee-cc.com
Web Page: www.manatee-cc.com/zns/

DECEMBER 2, 1997

FOXWOOD

DESCRIPTION: PARCEL 47

A PORTION OF TRACTS 6 AND 11, SECTION 29, TOWNSHIP 35 SOUTH, RANGE 20 EAST, POMELLO PARK, AS PER PLAT THEREOF, RECORDED IN PLAT BOOK 6, PAGE 61 OF THE PUBLIC RECORDS OF MANATEE COUNTY, FLORIDA, BEING MORE PARTICULARLY DESCRIBED AS FOLLOWS:

FROM THE SOUTHEAST CORNER OF SECTION 29, TOWNSHIP 35 SOUTH, RANGE 20 EAST, RUN N 66°55'01" W, A DISTANCE 4316.71 FEET TO THE POINT OF BEGINNING; THENCE N 88°46'00" W, A DISTANCE OF 1303.91 FEET; THENCE N 00°37'08" W, A DISTANCE OF 350.18 FEET; THENCE S 88°46'00" E, A DISTANCE OF 418.55 FEET; THENCE S 75°45'00" E, A DISTANCE OF 154.30 FEET; THENCE S 14°15'00" W, A DISTANCE OF 25.00 FEET; THENCE S 75°45'00" E, A DISTANCE OF 40.00 FEET; THENCE N 14°15'00" E, A DISTANCE OF 50.82 FEET; THENCE S 75°45'11" E, A DISTANCE OF 715.28 FEET; THENCE S 00°19'57" E, A DISTANCE OF 170.39 FEET TO THE POINT OF BEGINNING.

LESS AND EXCEPT ANY PORTION OF THE ABOVE DESCRIBED PARCEL WHICH FALLS WITHIN THE PLATTED ROAD RIGHTS OF WAY AS PER PLAT OF POMELLO PARK RECORDED IN PLAT BOOK 6, PAGE 61 OF THE PUBLIC RECORDS OF MANATEE COUNTY, FLORIDA.

BK 1543 PG 7213 44 of 75



201 5th Avenue Drive East
Post Office Box 9448
Bradenton, Florida 34206

(941) 748-8080
Fax (941) 748-3316
Survey Fax (941) 748-3747
E-mail: zns@manatee-cc.com
Web Page: www.manatee-cc.com/zns/

DECEMBER 2, 1997

FOXWOOD

DESCRIPTION: PARCEL 48

A PORTION OF TRACTS 10 AND 11, SECTION 29, TOWNSHIP 35 SOUTH, RANGE 20 EAST, POMELLO PARK, AS PER PLAT THEREOF, RECORDED IN PLAT BOOK 6, PAGE 61 OF THE PUBLIC RECORDS OF MANATEE COUNTY, FLORIDA, BEING MORE PARTICULARLY DESCRIBED AS FOLLOWS:

FROM THE SOUTHEAST CORNER OF SECTION 29, TOWNSHIP 35 SOUTH, RANGE 20 EAST, RUN N 79°26'44" W, A DISTANCE OF 4084.74 FEET TO THE POINT OF BEGINNING; THENCE N 88°45'15" W ALONG THE SOUTH LINE OF SAID TRACT 10, A DISTANCE OF 612.08 FEET; THENCE N 00°28'32" W ALONG A PORTION OF THE WEST LINE OF SAID TRACT 10 AND SAID TRACT 11, A DISTANCE OF 945.25 FEET; THENCE S 88°46'00" E, A DISTANCE OF 664.46 FEET; THENCE S 00°19'57" E, A DISTANCE OF 905.32 FEET; THENCE N 88°45'15" W, A DISTANCE OF 50.02 FEET; THENCE S 00°19'57" E, A DISTANCE OF 40.02 FEET TO THE POINT OF BEGINNING.

LESS AND EXCEPT ANY PORTION OF THE ABOVE DESCRIBED PARCEL WHICH FALLS WITHIN THE PLATTED ROAD RIGHTS OF WAY AS PER PLAT OF POMELLO PARK RECORDED IN PLAT BOOK 6, PAGE 61 OF THE PUBLIC RECORDS OF MANATEE COUNTY, FLORIDA.

BOOK 1543 PG 7214 45 of 75

OK



201 5th Avenue Drive East
Post Office Box 9448
Bradenton, Florida 34206

(941) 748-8080
Fax (941) 748-3316
Survey Fax (941) 748-3747
E-mail: zns@manatee-cc.com
Web Page: www.manatee-cc.com/zns/

NOVEMBER 26, 1997

FOXWOOD

DESCRIPTION: PARCEL 49

A PORTION OF TRACT 9, SECTION 29, TOWNSHIP 35 SOUTH, RANGE 20 EAST, POMELLO PARK, AS PER PLAT THEREOF, RECORDED IN PLAT BOOK 6, PAGE 61 OF THE PUBLIC RECORDS OF MANATEE COUNTY, FLORIDA, BEING MORE PARTICULARLY DESCRIBED AS FOLLOWS:

FROM THE SOUTHWEST CORNER OF SECTION 29, TOWNSHIP 35 SOUTH, RANGE 20 EAST, RUN N 89°05'06" E, A DISTANCE OF 660.18 FEET TO THE POINT OF BEGINNING; THENCE N 00°28'32" W ALONG A PORTION OF THE WEST LINE OF SAID TRACT 9, A DISTANCE OF 643.52 FEET; THENCE S 88°45'15" E ALONG THE NORTH NORTH LINE OF SAID TRACT 9, A DISTANCE OF 637.09 FEET; THENCE S 00°19'57" E, A DISTANCE OF 635.29 FEET; THENCE N 88°44'41" W, A DISTANCE OF 93.25 FEET TO THE POINT OF CURVATURE OF A CURVE TO THE RIGHT HAVING A RADIUS OF 1275.00 FEET; THENCE WESTERLY ALONG THE ARC OF SAID CURVE TO THE RIGHT, A DISTANCE OF 137.02 FEET THROUGH A CENTRAL ANGLE OF 06°09'27" TO A POINT OF REVERSE CURVATURE WITH A CURVE TO THE LEFT HAVING A RADIUS OF 1325.00 FEET; THENCE WESTERLY ALONG THE ARC OF SAID CURVE TO THE LEFT, A DISTANCE OF 343.87 FEET THROUGH A CENTRAL ANGLE OF 14°52'11" TO A POINT OF REVERSE CURVATURE WITH A CURVE TO THE RIGHT HAVING A RADIUS OF 1275.00 FEET; THENCE WESTERLY ALONG THE ARC OF SAID CURVE TO THE RIGHT, A DISTANCE OF 62.94 FEET THROUGH A CENTRAL ANGLE OF 02°49'42" TO THE POINT OF BEGINNING.

LESS AND EXCEPT ANY PORTION OF THE ABOVE DESCRIBED PARCEL WHICH FALLS WITHIN THE PLATTED ROAD RIGHTS OF WAY AS PER PLAT OF POMELLO PARK RECORDED IN PLAT BOOK 6, PAGE 61 OF THE PUBLIC RECORDS OF MANATEE COUNTY, FLORIDA.

BOOK 1543 PG 7215 46 of 75



201 5th Avenue Drive East
Post Office Box 9448
Bradenton, Florida 34206

(941) 748-8080
Fax (941) 748-3316
Survey Fax (941) 748-3747
E-mail: zns@manatee-cc.com
Web Page: www.manatee-cc.com/zns/

JANUARY 19, 1998

FOXWOOD

DESCRIPTION: PARCEL 50

A PORTION OF TRACT 16, POMELLO PARK, SECTION 32, TOWNSHIP 35 SOUTH, RANGE 20 EAST, AS PER PLAT THEREOF, RECORDED IN PLAT BOOK 6, PAGE 61 OF THE PUBLIC RECORDS OF MANATEE COUNTY FLORIDA, BEING MORE PARTICULARLY DESCRIBED AS FOLLOWS:

FROM THE NORTHWEST CORNER OF SECTION 32, TOWNSHIP 35 SOUTH, RANGE 20 EAST, RUN S 85°51'18" E, A DISTANCE OF 662.30 FEET TO THE POINT OF BEGINNING, ALSO BEING A POINT ON THE ARC OF A CURVE TO THE LEFT WHOSE RADIUS POINT LIES N 04°28'17" W, A DISTANCE OF 1325.00 FEET; THENCE EASTERLY ALONG THE ARC OF SAID CURVE TO THE LEFT, A DISTANCE OF 69.05 FEET THROUGH A CENTRAL ANGLE OF 02°59'08" TO A POINT OF REVERSE CURVATURE WITH A CURVE TO THE RIGHT HAVING A RADIUS OF 1275.00 FEET; THENCE EASTERLY ALONG THE ARC OF SAID CURVE TO THE RIGHT, A DISTANCE OF 250.14 FEET THROUGH A CENTRAL ANGLE OF 11°14'27"; THENCE S 00°27'58" E, A DISTANCE OF 713.08 FEET; THENCE N 88°51'51" W ALONG THE SOUTH LINE OF SAID TRACT 16, A DISTANCE OF 318.53 FEET; THENCE N 00°27'54" W ALONG THE WEST LINE OF SAID TRACT 16, A DISTANCE OF 691.58 FEET TO THE POINT OF BEGINNING.

LESS AND EXCEPT ANY PORTION OF THE ABOVE DESCRIBED PARCEL WHICH FALLS WITHIN THE PLATTED ROAD RIGHTS OF WAY AS PER PLAT OF POMELLO PARK, RECORDED IN PLAT BOOK 6, PAGE 61 OF THE PUBLIC RECORDS OF MANATEE COUNTY, FLORIDA.

BOOK 1543 PG 7216 47 of 75

14



201 5th Avenue Drive East
Post Office Box 9448
Bradenton, Florida 34206

(941) 748-8080
Fax (941) 748-3316
Survey Fax (941) 748-3747
E-mail: zns@manatee-cc.com
Web Page: www.manatee-cc.com/zns/

JANUARY 19, 1998

FOXWOOD

DESCRIPTION: PARCEL 50A

A PORTION OF TRACT 16, SECTION 32, TOWNSHIP 35 SOUTH, RANGE 20 EAST, POMELLO PARK AS PER PLAT THEREOF, RECORDED IN PLAT BOOK 6, PAGE 61 OF THE PUBLIC RECORDS OF MANATEE COUNTY, FLORIDA BEING MORE PARTICULARLY DESCRIBED AS FOLLOWS:

FROM THE NORTHWEST CORNER OF SECTION 32, TOWNSHIP 35 SOUTH, RANGE 20 EAST, RUN S 88°05'13" E, A DISTANCE 979.39 FEET TO THE POINT OF BEGINNING; ALSO BEING A POINT ON THE ARC OF A CURVE TO THE RIGHT WHOSE RADIUS POINT LIES S 03°47'02" W, A DISTANCE OF 1275.00 FEET; THENCE EASTERLY ALONG THE ARC OF SAID CURVE TO THE RIGHT, A DISTANCE OF 80.75 FEET THROUGH A CENTRAL ANGLE OF 03°37'44" TO A POINT OF REVERSE CURVATURE WITH A CURVE TO THE LEFT HAVING A RADIUS OF 1325.00 FEET; THENCE EASTERLY ALONG THE ARC OF SAID CURVE TO THE LEFT, A DISTANCE OF 142.40 FEET THROUGH A CENTRAL ANGLE OF 06°09'27" TO THE POINT OF TANGENCY; THENCE S 88°44'41" E, A DISTANCE OF 94.70 FEET; THENCE S 00°27'58" E, A DISTANCE OF 698.65 FEET; THENCE N 88°51'51" W ALONG THE SOUTH LINE OF SAID TRACT 16, A DISTANCE OF 316.89 FEET; THENCE N 00°27'58" W, A DISTANCE OF 713.08 FEET TO THE POINT OF BEGINNING.

LESS AND EXCEPT ANY PORTION OF THE ABOVE DESCRIBED PARCEL WHICH FALLS WITHIN THE PLATTED ROAD RIGHTS OF WAY AS PER PLAT OF POMELLO PARK, RECORDED IN PLAT BOOK 6, PAGE 61 OF THE PUBLIC RECORDS OF MANATEE COUNTY, FLORIDA.

PK 1543 PG 7217 48 of 75

12



201 5th Avenue Drive East
Post Office Box 9448
Bradenton, Florida 34206

(941) 748-8080
Fax (941) 748-3316
Survey Fax (941) 748-3747
E-mail: zns@manatee-cc.com
Web Page: www.manatee-cc.com/zns/

JANUARY 15, 1998

FOXWOOD

DESCRIPTIONS: PARCEL 51

A PORTION OF TRACT 51, POMELLO PARK, SECTION 32, TOWNSHIP 35 SOUTH, RANGE 20 EAST, AS PER PLAT THEREOF, RECORDED IN PLAT BOOK 6, PAGE 61 OF THE PUBLIC RECORDS OF MANATEE COUNTY, FLORIDA, BEING MORE PARTICULARLY DESCRIBED AS FOLLOWS:

FROM THE NORTHWEST CORNER OF SECTION 32, TOWNSHIP 35 SOUTH, RANGE 20 EAST, RUN S 42°01'01" E, A DISTANCE OF 995.27 FEET TO THE POINT OF BEGINNING; THENCE S 88°51'51" E ALONG THE NORTH LINE OF SAID TRACT 15, A DISTANCE OF 318.53 FEET; THENCE S 00°27'58" E, A DISTANCE OF 691.95 FEET TO A POINT ON THE ARC OF A CURVE TO THE LEFT WHOSE RADIUS POINT LIES S 07°10'27" W, A DISTANCE OF 1325.00 FEET; THENCE WESTERLY ALONG THE ARC OF SAID CURVE TO THE LEFT, A DISTANCE OF 319.21 FEET THROUGH A CENTRAL ANGLE OF 13°48'12"; THENCE N 00°27'54" W ALONG THE WEST LINE OF SAID TRACT 15, A DISTANCE OF 696.75 FEET TO THE POINT OF BEGINNING.

CONTAINING 5.03 ACRES, MORE OR LESS.

BK 1543 PG 7218 49 of 75



201 5th Avenue Drive East
Post Office Box 9448
Bradenton, Florida 34206

(941) 748-8080
Fax (941) 748-3316
Survey Fax (941) 748-3747
E-mail: zns@manatee-cc.com
Web Page: www.manatee-cc.com/zns/

JANUARY 15, 1998

FOXWOOD

DESCRIPTION: PARCEL 51A

A PORTION OF TRACT 15, SECTION 32, TOWNSHIP 35 SOUTH, RANGE 20 EAST, POMELLO PARK, AS PER PLAT THEREOF, RECORD IN PLAT BOOK 6, PAGE 61 OF THE PUBLIC RECORDS OF MANATEE COUNTY, FLORIDA, BEING MORE PARTICULARLY DESCRIBED AS FOLLOWS:

FROM THE NORTHWEST CORNER OF SECTION 32, TOWNSHIP 35 SOUTH, RANGE 20 EAST, RUN S 52°51'38" E, A DISTANCE OF 1235.18 FEET TO THE POINT OF BEGINNING; THENCE S 88°51'51" E ALONG THE NORTH LINE OF SAID TRACT 15, A DISTANCE OF 316.89 FEET; THENCE S 00°27'58" E, A DISTANCE OF 698.65 FEET; THENCE N 88°59'00" W, A DISTANCE OF 180.31 FEET TO THE P.C. OF A CURVE TO THE RIGHT HAVING A RADIUS OF 1275.00 FEET; THENCE WESTERLY ALONG THE ARC OF SAID CURVE TO THE RIGHT, A DISTANCE OF 137.02 FEET THROUGH A CENTRAL ANGLE OF 06°09'27"; THENCE N 00°27'58" W, A DISTANCE OF 691.95 FEET TO THE POINT OF BEGINNING.

BK 1543 PG 7219 50 of 75

h



201 5th Avenue Drive East
Post Office Box 9448
Bradenton, Florida 34206

(941) 748-8080
Fax (941) 748-3316
Survey Fax (941) 748-3747
E-mail: zns@manatee-cc.com
Web Page: www.manatee-cc.com/zns/

JANUARY 21, 1998

FOXWOOD

DESCRIPTION: PARCEL 52

A PORTION OF TRACTS 13 AND 14, POMELLO PARK, SECTION 32, TOWNSHIP 35 SOUTH, RANGE 20 EAST, AS PER PLAT THEREOF, RECORDED IN PLAT BOOK 6, PAGE 61 OF THE PUBLIC RECORDS OF MANATEE COUNTY, FLORIDA, BEING MORE PARTICULARLY DESCRIBED AS FOLLOWS:

FROM THE NORTHEAST CORNER OF SAID SECTION 32, RUN S 70°47'26" W, A DISTANCE OF 4209.18 FEET TO THE POINT OF BEGINNING; THENCE S 00°27'58" E, A DISTANCE OF 929.96 FEET; THENCE N 70°15'39" W, A DISTANCE OF 377.83 FEET; THENCE S 48°33'53" W, A DISTANCE OF 91.23 FEET; THENCE N 00°27'58" W, A DISTANCE OF 884.72 FEET TO A POINT ON THE ARC OF A CURVE TO THE RIGHT WHOSE RADIUS POINT LIES S 02°39'27" W, A DISTANCE OF 1275.00 FEET; THENCE ALONG THE ARC OF SAID CURVE TO THE RIGHT IN AN EASTERLY DIRECTION, A DISTANCE OF 100.51 FEET THROUGH A CENTRAL ANGLE OF 04°31'00" TO THE POINT OF REVERSE CURVATURE OF A CURVE TO THE LEFT WITH A RADIUS OF 1325.00 FEET; THENCE ALONG THE ARC OF SAID CURVE TO THE LEFT IN AN EASTERLY DIRECTION, A DISTANCE OF 142.40 FEET THROUGH A CENTRAL ANGLE OF 06°09'27" TO THE POINT OF TANGENCY OF SAID CURVE; THENCE S 88°59'00" E, A DISTANCE OF 181.60 FEET TO THE POINT OF BEGINNING.

LESS AND EXCEPT ANY PORTION OF THE ABOVE DESCRIBED PARCEL WHICH FALLS WITHIN THE PLATTED ROAD RIGHTS OF WAY AS PER PLAT OF POMELLO PARK, RECORDED IN PLAT BOOK 6, PAGE 61 OF THE PUBLIC RECORDS OF MANATEE COUNTY, FLORIDA.

BK 1543 PG 7220 51 of 75

R



201 5th Avenue Drive East
Post Office Box 9448
Bradenton, Florida 34206

(941) 748-8080
Fax (941) 748-3316
Survey Fax (941) 748-3747
E-mail: zns@manatee-cc.com
Web Page: www.manatee-cc.com/zns/

JANUARY 15, 1998

FOXWOOD

DESCRIPTION: PARCEL 53

A PORTION OF TRACTS 3, 4, 13 AND 14, POMELLO PARK, SECTION 32, TOWNSHIP 35 SOUTH, RANGE 20 EAST, AS PER PLAT THEREOF, RECORDED IN PLAT BOOK 6, PAGE 61 OF THE PUBLIC RECORDS OF MANATEE COUNTY, FLORIDA, BEING MORE PARTICULARLY DESCRIBED AS FOLLOWS:

FROM THE NORTHWEST CORNER OF SAID SECTION 32, RUN S 17°03'51" E, A DISTANCE OF 1569.73 FEET TO A POINT ON THE ARC OF A CURVE TO THE LEFT WHOSE RADIUS POINT LIES N 00°41'32" E, A DISTANCE OF 1325.00 FEET AND THE POINT OF BEGINNING; THENCE ALONG THE ARC OF SAID CURVE TO THE LEFT IN AN EASTERLY DIRECTION, A DISTANCE OF 193.98 FEET THROUGH A CENTRAL ANGLE OF 08°23'17" TO THE POINT OF REVERSE CURVATURE OF A CURVE TO THE RIGHT WITH A RADIUS OF 1275.00 FEET; THENCE ALONG THE ARC OF SAID CURVE TO THE RIGHT IN AN EASTERLY DIRECTION, A DISTANCE OF 230.39 FEET THROUGH A CENTRAL ANGLE OF 10°21'11"; THENCE S 00°27'58" E, A DISTANCE OF 884.72 FEET; THENCE S 50°08'57" W, A DISTANCE OF 547.88 FEET; THENCE N 00°27'58" W, A DISTANCE OF 1213.86 FEET TO THE POINT OF BEGINNING.

LESS AND EXCEPT ANY PORTION OF THE ABOVE DESCRIBED PARCEL WHICH FALLS WITHIN THE PLATTED ROAD RIGHTS OF WAY AS PER PLAT OF POMELLO PARK, RECORDED IN PLAT BOOK 6, PAGE 61 OF THE PUBLIC RECORDS OF MANATEE COUNTY, FLORIDA.

BK 1543 PG 7221 52 of 75



201 5th Avenue Drive East
Post Office Box 9448
Bradenton, Florida 34206

(941) 748-8080
Fax (941) 748-3316
Survey Fax (941) 748-3747
E-mail: zns@manatee-cc.com
Web Page: www.manatee-cc.com/zns/

JANUARY 21, 1998

FOXWOOD

DESCRIPTION: PARCEL 54

A PORTION OF TRACTS 3 AND 4, POMELLO PARK, SECTION 32, TOWNSHIP 35, RANGE 20 EAST, AS PER PLAT THEREOF, RECORDED IN PLAT BOOK 6, PAGE 61 OF THE PUBLIC RECORDS OF MANATEE COUNTY, FLORIDA, BEING MORE PARTICULARLY DESCRIBED AS FOLLOWS:

FROM THE NORTHWEST CORNER OF SAID SECTION 32, RUN S 00°27'50" E, A DISTANCE OF 1402.60 FEET TO THE POINT OF BEGINNING; THENCE S 88°59'00" E, A DISTANCE OF 137.60 FEET TO THE POINT OF CURVATURE OF A CURVE TO THE RIGHT WITH A RADIUS OF 1275.00 FEET; THENCE ALONG THE ARC OF SAID CURVE TO THE RIGHT IN AN EASTERLY DIRECTION, A DISTANCE OF 137.02 FEET THROUGH A CENTRAL ANGLE OF 06°09'27" TO THE POINT OF REVERSE CURVATURE OF A CURVE TO THE LEFT WITH A RADIUS OF 1325.00 FEET; THENCE ALONG THE ARC OF SAID CURVE TO THE LEFT IN A EASTERLY DIRECTION, A DISTANCE OF 149.90 FEET THROUGH A CENTRAL ANGLE OF 06°28'55"; THENCE S 00°27'58" E, A DISTANCE OF 882.23 FEET; THENCE N 89°59'05" W, A DISTANCE OF 423.50 FEET; THENCE N 00°27'50" W, A DISTANCE OF 904.62 FEET TO THE POINT OF BEGINNING.

BOOK 1543 PG 7222 53 of 75



201 5th Avenue Drive East
Post Office Box 9448
Bradenton, Florida 34206

JANUARY 22, 1998

(941) 748-8080
Fax (941) 748-3316
Survey Fax (941) 748-3747
E-mail: zns@manatee-cc.com
Web Page: www.manatee-cc.com/zns/

FOXWOOD

DESCRIPTION: PARCEL '55

TRACT 2, POMELLO PARK, SECTION 32, TOWNSHIP 35 SOUTH, RANGE 20 EAST, AS PER PLAT THEREOF, RECORDED IN PLAT BOOK 6, PAGE 61 OF THE PUBLIC RECORDS OF MANATEE COUNTY, FLORIDA, BEING MORE PARTICULARLY DESCRIBED AS FOLLOWS:

FROM THE NORTHEAST CORNER OF SAID SECTION 32, RUN S 82°18'20" W, A DISTANCE OF 4658.15 FEET TO THE POINT OF BEGINNING; THENCE S 00°27'54" E ALONG THE EAST LINE OF SAID TRACT 2, A DISTANCE OF 696.75 FEET TO A POINT ON THE ARC OF A CURVE TO THE LEFT WHOSE RADIUS POINT LIES S 06°37'46" E, A DISTANCE OF 1325.00 FEET; THENCE ALONG THE ARC OF SAID CURVE TO THE LEFT IN A WESTERLY DIRECTION, A DISTANCE OF 24.66 FEET THROUGH A CENTRAL ANGLE OF 01°03'59" TO THE POINT OF REVERSE CURVATURE OF A CURVE TO THE RIGHT WITH A RADIUS OF 1275.00 FEET; THENCE ALONG THE ARC OF SAID CURVE TO THE RIGHT IN A WESTERLY DIRECTION, A DISTANCE OF 330.90 FEET THROUGH A CENTRAL ANGLE OF 14°52'11" TO THE POINT OF REVERSE CURVATURE OF A CURVE TO THE LEFT WITH A RADIUS OF 1325.00 FEET; THENCE ALONG THE ARC OF SAID CURVE TO THE LEFT IN A WESTERLY DIRECTION, A DISTANCE OF 142.40 FEET THROUGH A CENTRAL ANGLE OF 06°09'27" TO THE POINT OF TANGENCY OF SAID CURVE; THENCE N 88°59'00" W, A DISTANCE OF 163.91 FEET; THENCE N 00°27'50" W, A DISTANCE OF 701.35 FEET; THENCE S 88°51'51" E ALONG THE WESTERLY EXTENSION OF THE NORTH LINE OF SAID TRACT 2 AND THE NORTH LINE OF SAID TRACT 2, A DISTANCE OF 660.43 FEET TO THE POINT OF BEGINNING.

LESS AND EXCEPT ANY PORTION OF THE ABOVE DESCRIBED PARCEL WHICH FALLS WITHIN THE PLATTED ROAD RIGHTS OF WAY AS PER PLAT OF POMELLO PARK, RECORDED IN PLAT BOOK 6, PAGE 61 OF THE PUBLIC RECORDS OF MANATEE COUNTY, FLORIDA.

BN 1543 PG 7223 54 OF 75

PC



201 5th Avenue Drive East
Post Office Box 9448
Bradenton, Florida 34206

(941) 748-8080
Fax (941) 748-3316
Survey Fax (941) 748-3747
E-mail: zns@manatee-cc.com
Web Page: www.manatee-cc.com/zns/

JANUARY 21, 1998

FOXWOOD

DESCRIPTION: PARCEL 56

A PORTION OF TRACT 1, POMELLO PARK, SECTION 32, TOWNSHIP 35 SOUTH, RANGE 20 EAST, AS PER PLAT THEREOF, RECORDED IN PLAT BOOK 6, PAGE 61 OF THE PUBLIC RECORDS OF MANATEE COUNTY, FLORIDA, BEING MORE PARTICULARLY DESCRIBED AS FOLLOWS:

FROM THE NORTHEAST CORNER OF SAID SECTION 32, RUN N 89°09'31" W, A DISTANCE OF 4622.32 FEET TO THE POINT OF BEGINNING; THENCE S 00°27'54" E ALONG THE EAST LINE OF SAID TRACT 1, A DISTANCE OF 691.58 FEET; THENCE N 88°51'51" W ALONG THE SOUTH LINE OF SAID TRACT 1 AND THE WESTERLY EXTENSION THEREOF, A DISTANCE OF 660.43 FEET; THENCE N 00°27'50" W, A DISTANCE OF 701.33 FEET; THENCE S 88°41'41" E, A DISTANCE OF 224.61 FEET TO THE POINT OF CURVATURE OF A CURVE TO THE RIGHT WITH A RADIUS OF 1275.00 FEET; THENCE ALONG THE ARC SAID CURVE TO THE RIGHT IN AN EASTERLY DIRECTION, A DISTANCE OF 137.02 FEET THROUGH A CENTRAL ANGLE OF 06°09'27" TO THE POINT OF REVERSE CURVATURE OF A CURVE TO THE LEFT WITH A RADIUS OF 1325.00 FEET; THENCE ALONG THE ARC OF SAID CURVE TO THE LEFT IN AN EASTERLY DIRECTION, A DISTANCE OF 274.83 FEET THROUGH A CENTRAL ANGLE OF 11°53'03" TO THE POINT OF BEGINNING.

LESS AND EXCEPT ANY PORTION OF THE ABOVE DESCRIBED PARCEL WHICH FALLS WITHIN THE PLATTED ROAD RIGHTS OF WAY AS PER PLAT OF POMELLO PARK, RECORDED IN PLAT BOOK 6, PAGE 61 OF THE PUBLIC RECORDS OF MANATEE COUNTY, FLORIDA.

BK 1543 PG 7224
55 of 75

02



201 5th Avenue Drive East
Post Office Box 9448
Bradenton, Florida 34206

(941) 748-8080
Fax (941) 748-3316
Survey Fax (941) 748-3747
E-mail: zns@manatee-cc.com
Web Page: www.manatee-cc.com/zns/

JANUARY 15, 1998

FOXWOOD

DESCRIPTION: PARCEL 57

A PORTION OF TRACT 8, SECTION 29, TOWNSHIP 35 SOUTH, RANGE 20 EAST, POMELLO PARK, AS PER PLAT THEREOF, RECORDED IN PLAT BOOK 6, PAGE 61 OF THE PUBLIC RECORDS OF MANATEE COUNTY, FLORIDA, BEING MORE PARTICULARLY DESCRIBED AS FOLLOWS:

FROM THE SOUTHWEST CORNER OF SECTION 29, TOWNSHIP 35 SOUTH, RANGE 20 EAST, RUN N 84°53'33" E, A DISTANCE OF 225.58 FEET TO THE POINT OF BEGINNING; THENCE N 00°28'00" W, A DISTANCE OF 635.16 FEET; THENCE S 88°45'15" E ALONG THE NORTH LINE OF SAID TRACT 8, A DISTANCE OF 435.41 FEET; THENCE S 00°28'32" E ALONG THE EAST LINE OF SAID TRACT 8, A DISTANCE OF 643.52 FEET TO A POINT ON THE ARC OF A CURVE TO THE RIGHT WHOSE RADIUS POINT LIES N 04°37'43" W, A DISTANCE OF 1275.00 FEET; THENCE WESTERLY ALONG THE ARC OF SAID CURVE TO THE RIGHT, A DISTANCE OF 267.96 FEET THROUGH A CENTRAL ANGLE OF 12°02'29" TO A POINT OF REVERSE CURVATURE WITH A CURVE TO THE LEFT HAVING A RADIUS OF 1325.00 FEET; THENCE WESTERLY ALONG THE ARC OF SAID CURVE TO THE LEFT, A DISTANCE OF 142.40 FEET THROUGH A CENTRAL ANGLE OF 06°09'27" TO THE POINT OF TANGENCY; THENCE N 88°44'41" W, A DISTANCE OF 26.17 FEET TO THE POINT OF BEGINNING.

LESS AND EXCEPT ANY PORTION OF THE ABOVE DESCRIBED PARCEL WHICH FALLS WITHIN THE PLATTED ROAD RIGHTS OF WAY AS PER PLAT OF POMELLO PARK, RECORDED IN PLAT BOOK 6, PAGE 61 OF THE PUBLIC RECORDS OF MANATEE COUNTY, FLORIDA.

DK 1543 PG 7225 56 of 75

R



201 5th Avenue Drive East
Post Office Box 9448
Bradenton, Florida 34206

(941) 748-8080
Fax (941) 748-3316
Survey Fax (941) 748-3747
E-mail: zns@manatee-cc.com
Web Page: www.manatee-cc.com/zns/

JANUARY 21, 1998

FOXWOOD

DESCRIPTION: PARCEL 58

A PORTION OF TRACTS 7 AND 8, POMELLO PARK, SECTION 29, TOWNSHIP 35 SOUTH, RANGE 20 EAST, AS PER PLAT THEREOF, RECORDED IN PLAT BOOK 6, PAGE 61 OF THE PUBLIC RECORDS OF MANATEE COUNTY, FLORIDA, BEING MORE PARTICULARLY DESCRIBED AS FOLLOWS:

FROM THE SOUTHEAST CORNER OF SAID SECTION 29, RUN N 88°27'42" W, A DISTANCE OF 5059.52 FEET TO THE POINT OF BEGINNING; THENCE N 88°44'41" W, A DISTANCE OF 200.00 FEET; THENCE N 00°37'08" W, A DISTANCE OF 1080.10 FEET; THENCE S 88°46'00" E, A DISTANCE OF 638.20 FEET; THENCE S 00°28'32" E ALONG THE EAST LINE OF SAID TRACT 7, A DISTANCE OF 445.03 FEET; THENCE N 88°45'15" W ALONG THE SOUTH LINE OF SAID TRACT 7, A DISTANCE OF 435.41 FEET; THENCE S 00°28'00" E, A DISTANCE OF 635.16 FEET TO THE POINT OF BEGINNING.

BK 1543 PG 7226 57 of 75

14



201 5th Avenue Drive East
Post Office Box 9448
Bradenton, Florida 34206

(941) 748-8080
Fax (941) 748-3316
Survey Fax (941) 748-3747
E-mail: zns@manatee-cc.com
Web Page: www.manatee-cc.com/zns/

JANUARY 22, 1998

FOXWOOD

DESCRIPTION: PARCEL 59

A PORTION OF TRACTS 6 AND 7, POMELLO PARK, SECTION 29, TOWNSHIP 35 SOUTH, RANGE 20 EAST AND TRACT 59, SECTION 30, TOWNSHIP 35 SOUTH, RANGE 20 EAST, POMELLO PARK, AS PER PLAT THEREOF, RECORDED IN PLAT BOOK 6, PAGE 61 OF THE PUBLIC RECORDS OF MANATEE COUNTY, FLORIDA, BEING MORE PARTICULARLY DESCRIBED AS FOLLOWS:

FROM THE SOUTHEAST CORNER OF SAID SECTION 29, RUN N 75°23'53" W, A DISTANCE OF 4785.84 FEET TO THE POINT OF BEGINNING; THENCE N 88°46'00" W, A DISTANCE OF 638.20 FEET; THENCE N 00°37'08" W, A DISTANCE OF 189.11 FEET; THENCE N 40°09'56" W, A DISTANCE OF 99.50 FEET TO A POINT ON THE ARC OF A CURVE TO THE LEFT WHOSE RADIUS POINT LIES N 46°32'42" W, A DISTANCE OF 225.00 FEET; THENCE ALONG THE ARC OF SAID CURVE TO THE LEFT IN A NORTHERLY DIRECTION, A DISTANCE OF 173.08 FEET THROUGH A CENTRAL ANGLE OF 44°04'26" TO THE POINT OF TANGENCY OF SAID CURVE; THENCE N 00°37'08" W, A DISTANCE OF 77.92 FEET; THENCE S 88°46'00" E, A DISTANCE OF 639.45 FEET; THENCE S 00°28'32" E ALONG THE EAST LINE OF SAID TRACT 6 AND THE EAST LINE OF SAID TRACT 7, A DISTANCE OF 500.22 FEET TO THE POINT OF BEGINNING.

LESS AND EXCEPT ANY PORTION OF THE ABOVE DESCRIBED PARCEL WHICH FALLS WITHIN THE PLATTED ROAD RIGHTS OF WAY AS PER PLAT OF POMELLO PARK, RECORDED IN PLAT BOOK 6, PAGE 61 OF THE PUBLIC RECORDS OF MANATEE COUNTY, FLORIDA.

BK 1543 PG 7277 58 of 75



201 5th Avenue Drive East
Post Office Box 9448
Bradenton, Florida 34206

(941) 748-8080
Fax (941) 748-3316
Survey Fax (941) 748-3747
E-mail: zns@manatee-cc.com
Web Page: www.manatee-cc.com/zns/

JANUARY 22, 1998

FOXWOOD

DESCRIPTION: PARCEL 60

A PORTION OF TRACTS 52 AND 61, POMELLO PARK, SECTION 30, TOWNSHIP 35 SOUTH, RANGE 20 EAST, AS PER PLAT THEREOF, RECORDED IN PLAT BOOK 6, PAGE 61 OF THE PUBLIC RECORDS OF MANATEE COUNTY, FLORIDA, BEING MORE PARTICULARLY DESCRIBED AS FOLLOWS:

FROM THE SOUTHEAST CORNER OF SAID SECTION 30, RUN N 01°09'40" W, A DISTANCE OF 2641.64 FEET TO THE POINT OF BEGINNING; THENCE N 88°50'41" W, A DISTANCE OF 1085.11 FEET; THENCE N 00°20'12" W, A DISTANCE OF 26.31 FEET TO THE POINT OF CURVATURE OF A CURVE TO THE LEFT WITH A RADIUS OF 225.00 FEET; THENCE ALONG THE ARC OF SAID CURVE TO THE LEFT IN A NORTHWESTERLY DIRECTION A DISTANCE OF 175.39 FEET THROUGH A CENTRAL ANGLE OF 44°39'48" TO THE POINT OF REVERSE CURVATURE OF A CURVE TO THE RIGHT WITH A RADIUS OF 175.00 FEET; THENCE ALONG THE ARC OF SAID CURVE TO THE RIGHT IN A NORTHERLY DIRECTION, A DISTANCE OF 161.13 FEET THROUGH A CENTRAL ANGLE OF 52°45'20" TO THE POINT OF TANGENCY OF SAID CURVE; THENCE N 07°45'21" E, A DISTANCE OF 73.01 FEET; THENCE N 00°52'45" E, A DISTANCE OF 14.74 FEET; THENCE S 69°55'48" E ALONG THE SOUTHERLY RIGHT OF WAY LINE OF THE FORMER EAST AND WEST COAST RAILROAD, A DISTANCE OF 1267.42 FEET; THENCE S 00°37'08" E, A DISTANCE OF 5.46 FEET TO THE POINT OF BEGINNING.

LESS AND EXCEPT ANY PORTION OF THE ABOVE DESCRIBED PARCEL WHICH FALLS WITHIN THE PLATTED ROAD RIGHTS OF WAY AS PER PLAT OF POMELLO PARK, RECORDED IN PLAT BOOK 6, PAGE 61 OF THE PUBLIC RECORDS OF MANATEE COUNTY, FLORIDA.

BK 1543 PG 7228 59 of 75

12



201 5th Avenue Drive East
Post Office Box 9448
Bradenton, Florida 34206

(941) 748-8080
Fax (941) 748-3316
Survey Fax (941) 748-3747
E-mail: zns@manatee-cc.com
Web Page: www.manatee-cc.com/zns/

JANUARY 21, 1998

FOXWOOD

DESCRIPTION: PARCEL 61

A PORTION OF TRACTS 44, 53 AND 60, POMELLO PARK, SECTION 30, TOWNSHIP 35 SOUTH, RANGE 20 EAST, AS PER PLAT THEREOF, RECORDED IN PLAT BOOK 6, PAGE 61 OF THE PUBLIC RECORDS OF MANATEE COUNTY, FLORIDA, BEING MORE PARTICULARLY DESCRIBED AS FOLLOWS:

FROM THE SOUTHEAST CORNER OF SAID SECTION 30, RUN N 01°12'04" W, A DISTANCE OF 2459.14 FEET TO THE POINT OF BEGINNING; THENCE S 76°55'19" W, A DISTANCE OF 1220.13 FEET TO A POINT ON THE ARC OF A CURVE TO THE RIGHT WHOSE RADIUS POINT LIES N 77°56'42" E, A DISTANCE OF 275.00 FEET; THENCE ALONG THE ARC OF SAID CURVE TO THE RIGHT IN A NORTHERLY DIRECTION, A DISTANCE OF 225.56 FEET THROUGH A CENTRAL ANGLE OF 46°59'40" TO A POINT OF REVERSE CURVATURE OF A CURVE TO THE LEFT WITH A RADIUS OF 325.00 FEET; THENCE ALONG THE ARC OF SAID CURVE TO THE LEFT IN A NORTHERLY DIRECTION, A DISTANCE OF 200.10 FEET THROUGH A CENTRAL ANGLE OF 35°16'35" TO THE POINT OF TANGENCY OF SAID CURVE; THENCE N 00°20'12" W ALONG THE WEST LINE OF SAID TRACT 53, A DISTANCE OF 77.49 FEET; THENCE S 88°50'41" E, A DISTANCE OF 1085.11 FEET; THENCE S 00°37'08" E ALONG THE NORTHERLY EXTENSION OF THE EAST LINE OF SAID TRACT 60 AND EAST LINE OF SAID TRACT 60, A DISTANCE OF 182.51 FEET TO THE POINT OF BEGINNING.

EX 1543 PG 7229 60 of 75



201 5th Avenue Drive East
Post Office Box 9448
Bradenton, Florida 34206

(941) 748-8080
Fax (941) 748-3316
Survey Fax (941) 748-3747
E-mail: zns@manatee-cc.com
Web Page: www.manatee-cc.com/zns/

JANUARY 8, 1998

FOXWOOD

DESCRIPTION: PARCEL 62

A PORTION OF TRACTS 59 AND 60, POMELLO PARK, SECTION 30, TOWNSHIP 35 SOUTH, RANGE 20 EAST, AS PER PLAT THEREOF, RECORDED IN PLAT BOOK 6, PAGE 61 OF THE PUBLIC RECORDS OF MANATEE COUNTY, FLORIDA, BEING MORE PARTICULARLY DESCRIBED AS FOLLOWS:

FROM THE SOUTHEAST CORNER OF SAID SECTION 30, RUN N 01°24'42" W, A DISTANCE OF 1806.56 FEET TO THE POINT OF BEGINNING; THENCE N 77°52'00" W, A DISTANCE OF 557.85 FEET; THENCE N 00°28'40" W ALONG THE WEST LINE OF SAID TRACT 59 AND TRACT 60, A DISTANCE OF 409.50 FEET; THENCE N 76°55'19" E, A DISTANCE OF 556.18 FEET; THENCE S 00°37'08" E ALONG THE EAST LINE OF SAID TRACT 60 AND TRACT 59, A DISTANCE OF 652.63 FEET TO THE POINT OF BEGINNING.

BK 1543 PG 7230 61 of 75

AE



201 5th Avenue Drive East
Post Office Box 9448
Bradenton, Florida 34206

(941) 748-8080
Fax (941) 748-3316
Survey Fax (941) 748-3747
E-mail: zns@manatee-cc.com
Web Page: www.manatee-cc.com/zns/

JANUARY 21, 1998

FOXWOOD

DESCRIPTION: PARCEL 63

A PORTION OF TRACT 59, POMELLO PARK, SECTION 30, TOWNSHIP 35 SOUTH, RANGE 20 EAST, AS PER PLAT THEREOF, RECORDED IN PLAT BOOK 6, PAGE 61 OF THE PUBLIC RECORDS OF MANATEE COUNTY, FLORIDA, BEING MORE PARTICULARLY DESCRIBED AS FOLLOWS:

FROM THE SOUTHEAST CORNER OF SAID SECTION 30, RUN N 09°15'32" W, A DISTANCE OF 1367.24 FEET TO THE POINT OF BEGINNING; THENCE N 88°51'08" W ALONG THE SOUTH LINE OF SAID TRACT 59, A DISTANCE OF 365.26 FEET; THENCE N 00°28'40" W ALONG THE WEST LINE OF SAID TRACT 59, A DISTANCE OF 566.54 FEET; THENCE S 77°52'00" E, A DISTANCE OF 557.85 FEET; THENCE S 00°37'08" E, A DISTANCE OF 279.75 FEET TO THE POINT OF CURVATURE OF A CURVE TO THE RIGHT WITH A RADIUS OF 175.00 FEET; THENCE ALONG THE ARC OF SAID CURVE TO THE RIGHT IN A SOUTHWESTERLY DIRECTION, A DISTANCE OF 280.28 FEET THROUGH A CENTRAL ANGLE OF 91°45'59" TO THE POINT OF BEGINNING.

BM 1543 PG 7231 62 of 75

BE.



201 5th Avenue Drive East
Post Office Box 9448
Bradenton, Florida 34206

(941) 748-8080
Fax (941) 748-3316
Survey Fax (941) 748-3747
E-mail: zns@manatee-cc.com
Web Page: www.manatee-cc.com/zns/

JANUARY 21, 1998

FOXWOOD

DESCRIPTION: PARCEL 64

A PORTION OF TRACT 58, POMELLO PARK, SECTION 30, TOWNSHIP 35 SOUTH, RANGE 20 EAST, AS PER PLAT THEREOF, RECORDED IN PLAT BOOK 6, PAGE 61 OF THE PUBLIC RECORDS OF MANATEE COUNTY, FLORIDA, BEING MORE PARTICULARLY DESCRIBED AS FOLLOWS:

FROM THE SOUTHEAST CORNER OF SAID SECTION 30, RUN N 02°47'07" W, A DISTANCE OF 661.28 FEET TO THE POINT OF BEGINNING; THENCE N 88°50'54" W ALONG THE SOUTH LINE OF SAID TRACT 58, A DISTANCE OF 547.43 FEET; THENCE N 00°28'40" W ALONG THE WEST LINE OF SAID TRACT 58, A DISTANCE OF 635.24 FEET; THENCE S 88°51'08" E, A DISTANCE OF 363.84 FEET TO THE POINT OF CURVATURE OF A CURVE TO THE LEFT WITH A RADIUS OF 225.00 FEET; THENCE ALONG THE ARC OF SAID CURVE TO THE LEFT IN AN EASTERLY DIRECTION, A DISTANCE OF 137.19 FEET THROUGH A CENTRAL ANGLE OF 34°56'02"; THENCE S 40°09'56" E, A DISTANCE OF 81.52 FEET; THENCE S 00°37'08" E ALONG THE EAST LINE OF SAID TRACT 58, A DISTANCE OF 614.62 FEET TO THE POINT OF BEGINNING.

LESS AND EXCEPT ANY PORTION OF THE ABOVE DESCRIBED PARCEL WHICH FALLS WITHIN THE PLATTED ROAD RIGHTS OF WAY AS PER PLAT OF POMELLO PARK, RECORDED IN PLAT BOOK 6, PAGE 61 OF THE PUBLIC RECORDS OF MANATEE COUNTY, FLORIDA.

DK 1543 PG 7232 63 of 75



201 5th Avenue Drive East
Post Office Box 9448
Bradenton, Florida 34206

(941) 748-8080
Fax (941) 748-3316
Survey Fax (941) 748-3747
E-mail: zns@manatee-cc.com
Web Page: www.manatee-cc.com/zns/

JANUARY 21, 1998

FOXWOOD

DESCRIPTION: PARCEL 65

A PORTION OF TRACT 57, POMELLO PARK, SECTION 30, TOWNSHIP 35 SOUTH, RANGE 20 EAST, AS PER PLAT THEREOF, RECORDED IN PLAT BOOK 6, PAGE 61 OF THE PUBLIC RECORDS OF MANATEE COUNTY, FLORIDA, BEING MORE PARTICULARLY DESCRIBED AS FOLLOWS:

FROM THE SOUTHEAST CORNER OF SAID SECTION 30, RUN N 44°44'21" W, A DISTANCE OF 35.91 FEET TO THE POINT OF BEGINNING; THENCE N 88°51'34" W ALONG THE SOUTH LINE OF SAID TRACT 57, A DISTANCE OF 41.76 FEET TO THE POINT OF CURVATURE OF A CURVE TO THE RIGHT WITH A RADIUS OF 1275.00 FEET; THENCE ALONG THE ARC OF SAID CURVE TO THE RIGHT IN A WESTERLY DIRECTION, A DISTANCE OF 137.02 FEET THROUGH A CENTRAL ANGLE OF 06°09'27" TO THE POINT OF REVERSE CURVATURE OF A CURVE TO THE LEFT WITH A RADIUS OF 1325.00 FEET; THENCE ALONG THE ARC OF SAID CURVE TO THE LEFT IN A WESTERLY DIRECTION, A DISTANCE OF 343.87 FEET THROUGH A CENTRAL ANGLE OF 14°52'11" TO A POINT OF REVERSE CURVATURE OF A CURVE TO THE RIGHT WITH A RADIUS OF 1275.00 FEET; THENCE ALONG THE ARC OF SAID CURVE TO THE RIGHT IN A WESTERLY DIRECTION, A DISTANCE OF 27.81 FEET THROUGH A CENTRAL ANGLE OF 01°14'59" TO THE END OF SAID CURVE; THENCE N 00°28'40" W ALONG THE SOUTHERLY EXTENSION OF THE WEST LINE OF SAID TRACT 57 AND THE WEST LINE OF SAID TRACT 57, A DISTANCE OF 639.29 FEET; THENCE S 88°50'54" E ALONG THE NORTH LINE OF SAID TRACT 57, A DISTANCE OF 547.43 FEET; THENCE S 00°37'08" E ALONG THE EAST LINE OF SAID TRACT 57, A DISTANCE OF 635.03 FEET TO THE POINT OF BEGINNING.

LESS AND EXCEPT ANY PORTION OF THE ABOVE DESCRIBED PARCEL WHICH FALLS WITHIN THE PLATTED ROAD RIGHTS OF WAY AS PER PLAT OF POMELLO PARK, RECORDED IN PLAT BOOK 6, PAGE 61 OF THE PUBLIC RECORDS OF MANATEE COUNTY, FLORIDA.

BN 1543 PG 7233 64 of 75



201 5th Avenue Drive East
Post Office Box 9448
Bradenton, Florida 34206

(941) 748-8080
Fax (941) 748-3316
Survey Fax (941) 748-3747
E-mail: zns@manatee-cc.com
Web Page: www.manatee-cc.com/zns/

JANUARY 21, 1998

FOXWOOD

DESCRIPTION: PARCEL 66

TRACT 64, POMELLO PARK, SECTION 31, TOWNSHIP 35 SOUTH, RANGE 20 EAST, AS PER PLAT THEREOF, RECORDED IN PLAT BOOK 6, PAGE 61 OF THE PUBLIC RECORDS OF MANATEE COUNTY, FLORIDA, BEING MORE PARTICULARLY DESCRIBED AS FOLLOWS:

FROM THE NORTHEAST CORNER OF SAID SECTION 31, RUN S 00°27'50" E, A DISTANCE OF 25.04 FEET TO THE POINT OF BEGINNING; THENCE CONTINUE S 00°27'50" E, A DISTANCE OF 701.35 FEET; THENCE N 89°00'34" W ALONG THE EASTERLY EXTENSION OF THE SOUTH LINE OF SAID TRACT 64 AND ALONG THE SOUTH LINE OF SAID TRACT 64, A DISTANCE OF 575.73 FEET; THENCE N 00°19'46" W ALONG THE WEST LINE OF SAID TRACT 64, A DISTANCE OF 698.37 FEET TO A POINT ON THE ARC OF A CURVE TO THE LEFT WHOSE RADIUS POINT LIES N 06°05'51" W, A DISTANCE OF 1325.00 FEET; THENCE ALONG THE ARC OF SAID CURVE TO THE LEFT IN AN EASTERLY DIRECTION A DISTANCE OF 34.09 FEET THROUGH A CENTRAL ANGLE OF 01°28'27" TO THE POINT OF REVERSE CURVATURE OF A CURVE TO THE RIGHT WITH A RADIUS OF 1275.00 FEET; THENCE ALONG THE ARC OF SAID CURVE TO THE RIGHT IN AN EASTERLY DIRECTION, A DISTANCE OF 330.90 FEET THROUGH A CENTRAL ANGLE OF 14°52'11" TO THE POINT OF REVERSE CURVATURE OF A CURVE TO THE LEFT WITH A RADIUS OF 1325.00 FEET; THENCE EASTERLY ALONG THE ARC OF SAID CURVE, A DISTANCE OF 142.40 FEET THROUGH A CENTRAL ANGLE OF 06°09'27" TO THE POINT OF TANGENCY OF SAID CURVE; THENCE S 88°51'34" E ALONG THE NORTH LINE OF SAID TRACT 64 AND THE EASTERLY EXTENSION OF SAID NORTH LINE, A DISTANCE OF 68.24 FEET TO THE POINT OF BEGINNING.

LESS AND EXCEPT ANY PORTION OF THE ABOVE DESCRIBED PARCEL WHICH FALLS WITHIN THE PLATTED ROAD RIGHTS OF WAY AS PER PLAT OF POMELLO PARK, RECORDED IN PLAT BOOK 6, PAGE 61 OF THE PUBLIC RECORDS OF MANATEE COUNTY, FLORIDA.

BOOK 1543 PG 7234 65 of 75

06



201 5th Avenue Drive East
Post Office Box 9448
Bradenton, Florida 34206

(941) 748-8080
Fax (941) 748-3316
Survey Fax (941) 748-3747
E-mail: zns@manatee-cc.com
Web Page: www.manatee-cc.com/zns/

JANUARY 21, 1998

FOXWOOD

DESCRIPTION: PARCEL 67

A PORTION OF TRACT 63, POMELLO PARK, SECTION 31, TOWNSHIP 35 SOUTH, RANGE 20 EAST, AS PER PLAT THEREOF, RECORDED IN PLAT BOOK 6, PAGE 61 OF THE PUBLIC RECORDS OF MANATEE COUNTY, FLORIDA, BEING MORE PARTICULARLY DESCRIBED AS FOLLOWS:

FROM THE NORTHEAST CORNER OF SAID SECTION 31, RUN S 00°27'50" E, A DISTANCE OF 726.36 FEET TO THE POINT OF BEGINNING; THENCE CONTINUE S 00°27'50" E, A DISTANCE OF 701.35 FEET; THENCE N 89°09'30" W, A DISTANCE OF 119.41 FEET TO THE POINT OF CURVATURE OF A CURVE TO THE RIGHT WITH A RADIUS OF 1275.00 FEET; THENCE ALONG THE ARC OF SAID CURVE TO THE RIGHT IN A WESTERLY DIRECTION, A DISTANCE OF 137.02 FEET THROUGH A CENTRAL ANGLE OF 06°09'27" TO THE POINT OF REVERSE CURVATURE OF A CURVE TO THE LEFT WITH A RADIUS OF 1325.00 FEET; THENCE ALONG THE ARC OF SAID CURVE TO THE LEFT IN A WESTERLY DIRECTION, A DISTANCE OF 322.06 FEET THROUGH A CENTRAL ANGLE OF 13°55'36"; THENCE N 00°19'46" W ALONG THE WEST LINE OF SAID TRACT 63, A DISTANCE OF 699.98 FEET; THENCE S 89°00'34" E ALONG THE NORTH LINE OF SAID TRACT 63, A DISTANCE OF 575.73 FEET TO THE POINT OF BEGINNING.

LESS AND EXCEPT ANY PORTION OF THE ABOVE DESCRIBED PARCEL WHICH FALLS WITHIN THE PLATTED ROAD RIGHTS OF WAY AS PER PLAT OF POMELLO PARK, RECORDED IN PLAT BOOK 6, PAGE 61 OF THE PUBLIC RECORDS OF MANATEE COUNTY, FLORIDA.

BK 1543 PG 7235 66 of 75



201 5th Avenue Drive East
Post Office Box 9448
Bradenton, Florida 34206

(941) 748-8080
Fax (941) 748-3316
Survey Fax (941) 748-3747
E-mail: zns@manatee-cc.com
Web Page: www.manatee-cc.com/zns/

JANUARY 21, 1998

FOXWOOD

DESCRIPTION: PARCEL 68

TRACT 62, POMELLO PARK, SECTION 31, TOWNSHIP 35 SOUTH, RANGE 20 EAST, AS PER PLAT THEREOF, RECORDED IN PLAT BOOK 6, PAGE 61 OF THE PUBLIC RECORDS OF MANATEE COUNTY, FLORIDA, BEING MORE PARTICULARLY DESCRIBED AS FOLLOWS:

FROM THE NORTHEAST CORNER OF SAID SECTION 31, RUN S 00°30'20" W, A DISTANCE OF 1477.37 FEET TO THE POINT OF BEGINNING; THENCE CONTINUE S 00°27'50" E, A DISTANCE OF 701.42 FEET; THENCE N 89°18'23" W ALONG THE SOUTH LINE OF SAID TRACT 62, A DISTANCE OF 554.07 FEET; THENCE N 00°19'46" W, A DISTANCE OF 705.32 FEET TO A POINT ON THE ARC OF A CURVE TO THE RIGHT WHOSE RADIUS POINT LIES S 07°11'15" E, A DISTANCE OF 1275.00 FEET; THENCE ALONG THE ARC OF SAID CURVE TO THE RIGHT IN AN EASTERLY DIRECTION, A DISTANCE OF 315.69 FEET THROUGH A CENTRAL ANGLE OF 14°11'12" TO THE POINT OF REVERSE CURVATURE OF A CURVE TO THE LEFT WITH A RADIUS OF 1325.00 FEET; THENCE ALONG THE ARC OF SAID CURVE TO THE LEFT IN AN EASTERLY DIRECTION, A DISTANCE OF 142.40 FEET THROUGH A CENTRAL ANGLE OF 06°09'27" TO THE POINT OF TANGENCY OF SAID CURVE; THENCE S 89°09'30" E, A DISTANCE OF 95.94 FEET TO THE POINT OF BEGINNING.

LESS AND EXCEPT ANY PORTION OF THE ABOVE DESCRIBED PARCEL WHICH FALLS WITHIN THE PLATTED ROAD RIGHTS OF WAY AS PER PLAT OF POMELLO PARK, RECORDED IN PLAT BOOK 6, PAGE 61 OF THE PUBLIC RECORDS OF MANATEE COUNTY, FLORIDA.

BK 1543 PG 7236 67 of 75



201 5th Avenue Drive East
Post Office Box 9448
Bradenton, Florida 34206

(941) 748-8080
Fax (941) 748-3316
Survey Fax (941) 748-3747
E-mail: zns@manatee-cc.com
Web Page: www.manatee-cc.com/zns/

JANUARY 16, 1998

FOXWOOD

DESCRIPTION: PARCEL 69

A PORTION OF TRACT 51, POMELLO PARK, SECTION 31, TOWNSHIP 35 SOUTH, RANGE 20 EAST, AS PER PLAT THEREOF, RECORDED IN PLAT BOOK 6, PAGE 61 OF THE PUBLIC RECORDS OF MANATEE COUNTY, FLORIDA, BEING MORE PARTICULARLY DESCRIBED AS FOLLOWS:

FROM THE NORTHEAST CORNER OF SAID SECTION 31, RUN S 14°29'31" W, A DISTANCE OF 2243.38 FEET TO THE POINT OF BEGINNING; THENCE N 89°18'23" W ALONG THE SOUTH LINE OF SAID TRACT 51, A DISTANCE OF 556.06 FEET; THENCE N 05°25'46" W, A DISTANCE OF 108.52 FEET TO THE POINT OF CURVATURE OF A CURVE TO THE RIGHT WITH A RADIUS OF 575.00 FEET; THENCE ALONG THE ARC OF SAID CURVE TO THE RIGHT IN A NORTHERLY DIRECTION, A DISTANCE OF 445.66 FEET THROUGH A CENTRAL ANGLE OF 44°24'27" TO THE POINT OF REVERSE CURVATURE OF A CURVE TO THE LEFT WITH A RADIUS OF 425.00 FEET; THENCE ALONG THE ARC OF SAID CURVE TO THE LEFT IN A NORTHERLY DIRECTION, A DISTANCE OF 195.02 FEET THROUGH A CENTRAL ANGLE OF 26°17'28"; THENCE S 80°41'08" E, A DISTANCE OF 72.82 FEET TO THE POINT OF CURVATURE OF A CURVE TO THE LEFT WITH A RADIUS OF 625.00 FEET; THENCE ALONG THE ARC OF SAID CURVE TO THE LEFT IN AN EASTERLY DIRECTION, A DISTANCE OF 213.75 FEET THROUGH A CENTRAL ANGLE OF 19°35'41" TO THE POINT OF REVERSE CURVATURE OF A CURVE TO THE RIGHT WITH A RADIUS OF 1275.00 FEET; THENCE ALONG THE ARC OF SAID CURVE TO THE RIGHT IN AN EASTERLY DIRECTION, A DISTANCE OF 68.82 FEET THROUGH A CENTRAL ANGLE OF 03°05'34"; THENCE S 00°19'46" E ALONG THE EAST LINE OF SAID TRACT 51, A DISTANCE OF 705.32 FEET TO THE POINT OF BEGINNING.

LESS AND EXCEPT ANY PORTION OF THE ABOVE DESCRIBED PARCEL WHICH FALLS WITHIN THE PLATTED ROAD RIGHTS OF WAY AS PER PLAT OF POMELLO PARK, RECORDED IN PLAT BOOK 6, PAGE 61 OF THE PUBLIC RECORDS OF MANATEE COUNTY, FLORIDA.

OK 1543 PG 7237 68 of 75

RE



201 5th Avenue Drive East
Post Office Box 9448
Bradenton, Florida 34206

(941) 748-8080
Fax (941) 748-3316
Survey Fax (941) 748-3747
E-mail: zns@manatee-cc.com
Web Page: www.manatee-cc.com/zns/

JANUARY 21, 1998

FOXWOOD

DESCRIPTION: PARCEL 70

A PORTION OF TRACT 50, POMELLO PARK, SECTION 31, TOWNSHIP 35 SOUTH, RANGE 20 EAST, AS PER PLAT THEREOF, RECORDED IN PLAT BOOK 6, PAGE 61 OF THE PUBLIC RECORDS OF MANATEE COUNTY, FLORIDA, BEING MORE PARTICULARLY DESCRIBED AS FOLLOWS:

FROM THE NORTHEAST CORNER OF SAID SECTION 31, RUN S 38°29'47" W, A DISTANCE OF 915.34 FEET TO THE POINT OF BEGINNING; THENCE S 00°19'46" E ALONG THE EAST LINE OF SAID TRACT 50, A DISTANCE OF 699.98 FEET TO A POINT ON THE ARC OF A CURVE TO THE LEFT WHOSE RADIUS POINT LIES S 06°55'39" E, A DISTANCE OF 1325.00 FEET; THENCE ALONG THE ARC OF SAID CURVE TO THE LEFT IN A WESTERLY DIRECTION, A DISTANCE OF 77.53 FEET THROUGH A CENTRAL ANGLE OF 03°21'10" TO THE POINT OF REVERSE CURVATURE OF A CURVE TO THE RIGHT WITH A RADIUS OF 575.00 FEET; THENCE ALONG THE ARC OF SAID CURVE TO THE RIGHT IN A WESTERLY DIRECTION, A DISTANCE OF 196.65 FEET THROUGH A CENTRAL ANGLE OF 19°35'14" TO THE POINT OF TANGENCY OF SAID CURVE; THEN N 80°41'08" W, A DISTANCE OF 72.82 FEET TO A POINT ON THE ARC OF A CURVE TO THE LEFT WHOSE RADIUS POINT LIES N 84°03'28" W, A DISTANCE OF 425.00 FEET; THENCE ALONG THE ARC OF SAID CURVE TO THE LEFT IN A NORTHERLY DIRECTION, A DISTANCE OF 253.08 FEET THROUGH A CENTRAL ANGLE OF 34°07'07" TO THE POINT OF REVERSE CURVATURE OF A CURVE TO THE RIGHT WITH A RADIUS OF 1475.00 FEET; THENCE ALONG THE ARC OF SAID CURVE TO THE RIGHT IN A NORTHERLY DIRECTION, A DISTANCE OF 494.11 FEET THROUGH A CENTRAL ANGLE OF 19°11'36"; THENCE S 89°00'34" E ALONG THE NORTH LINE OF SAID TRACT 50, A DISTANCE OF 545.02 FEET TO THE POINT OF BEGINNING.

LESS AND EXCEPT ANY PORTION OF THE ABOVE DESCRIBED PARCEL WHICH FALLS WITHIN THE PLATTED ROAD RIGHTS OF WAY AS PER PLAT OF POMELLO PARK, RECORDED IN PLAT BOOK 6, PAGE 61 OF THE PUBLIC RECORDS OF MANATEE COUNTY, FLORIDA.

BK 1543 PG 7238 69 of 75



201 5th Avenue Drive East
Post Office Box 9448
Bradenton, Florida 34206

(941) 748-8080
Fax (941) 748-3316
Survey Fax (941) 748-3747
E-mail: zns@manatee-cc.com
Web Page: www.manatee-cc.com/zns/

JANUARY 21, 1998

FOXWOOD

DESCRIPTION: PARCEL 71

A PORTION OF TRACT 49, POMELLO PARK, SECTION 31, TOWNSHIP 35 SOUTH, RANGE 20 EAST, AS PER PLAT THEREOF, RECORDED IN PLAT BOOK 6, PAGE 61 OF THE PUBLIC RECORDS OF MANATEE COUNTY, FLORIDA, BEING MORE PARTICULARLY DESCRIBED AS FOLLOWS:

FROM THE NORTHEAST CORNER OF SAID SECTION 31, RUN S 88°12'03" W, A DISTANCE OF 574.07 FEET TO THE POINT OF BEGINNING; THENCE S 00°19'46" E ALONG THE EAST LINE OF SAID TRACT 49, A DISTANCE OF 698.37 FEET; THENCE N 89°00'34" W ALONG THE SOUTH LINE OF SAID TRACT 49, A DISTANCE OF 545.02 FEET TO A POINT ON THE ARC OF A CURVE TO THE RIGHT WHOSE RADIUS LIES N 81°01'02" E, A DISTANCE OF 1475.00 FEET; THENCE ALONG THE ARC OF SAID CURVE TO THE RIGHT IN A NORTHERLY DIRECTION, A DISTANCE OF 356.03 FEET THROUGH A CENTRAL ANGLE OF 13°49'47" TO THE POINT OF REVERSE CURVATURE OF A CURVE TO THE LEFT WITH A RADIUS OF 1525.00 FEET; THENCE ALONG THE ARC OF SAID CURVE TO THE LEFT IN A NORTHERLY DIRECTION, A DISTANCE OF 134.22 FEET THROUGH A CENTRAL ANGLE OF 05°02'33" TO THE POINT OF TANGENCY OF SAID CURVE; THENCE N 00°11'45" W, A DISTANCE OF 215.32 FEET; THENCE S 88°51'34" E, A DISTANCE OF 103.41 FEET TO THE POINT OF CURVATURE OF A CURVE TO THE RIGHT WITH A RADIUS OF 1275.00 FEET; THENCE ALONG THE ARC OF SAID CURVE TO THE RIGHT IN AN EASTERLY DIRECTION, A DISTANCE OF 137.02 FEET THROUGH A CENTRAL ANGLE OF 06°09'27" TO THE POINT OF REVERSE CURVATURE OF A CURVE TO THE LEFT WITH A RADIUS OF 1325.00 FEET; THENCE ALONG THE ARC OF SAID CURVE TO THE LEFT IN AN EASTERLY DIRECTION, A DISTANCE OF 309.78 FEET THROUGH A CENTRAL ANGLE OF 13°23'44" TO THE POINT OF BEGINNING.

LESS AND EXCEPT ANY PORTION OF THE ABOVE DESCRIBED PARCEL WHICH FALLS WITHIN THE PLATTED ROAD RIGHTS OF WAY AS PER PLAT OF POMELLO PARK, RECORDED IN PLAT BOOK 6, PAGE 61 OF THE PUBLIC RECORDS OF MANATEE COUNTY, FLORIDA.

DK 1543 PG 7237 70 of 75



201 5th Avenue Drive East
Post Office Box 9448
Bradenton, Florida 34206

JANUARY 21, 1998

(941) 748-8080
Fax (941) 748-3316
Survey Fax (941) 748-3747
E-mail: zns@manatee-cc.com
Web Page: www.manatee-cc.com/zns/

FOXWOOD

DESCRIPTION: PARCEL 72

TRACT 56, POMELLO PARK, SECTION 30, TOWNSHIP 35 SOUTH, RANGE 20 EAST, AS PER PLAT THEREOF, RECORDED IN PLAT BOOK 6, PAGE 61 OF THE PUBLIC RECORDS OF MANATEE COUNTY, FLORIDA, BEING MORE PARTICULARLY DESCRIBED AS FOLLOWS:

FROM THE SOUTHEAST CORNER OF SAID SECTION 30, RUN N $86^{\circ}47'12''$ W, A DISTANCE OF 575.03 FEET TO A POINT ON THE ARC OF A CURVE TO THE RIGHT WHOSE RADIUS LIES N $06^{\circ}19'20''$ W, A DISTANCE OF 1275.00 FEET AND THE POINT OF BEGINNING; THENCE ALONG THE ARC OF SAID CURVE TO THE RIGHT IN A WESTERLY DIRECTION, A DISTANCE OF 303.09 FEET THROUGH A CENTRAL ANGLE OF $13^{\circ}37'12''$ TO THE POINT OF REVERSE CURVATURE OF A CURVE TO THE LEFT WITH A RADIUS OF 1325.00 FEET; THENCE ALONG THE ARC OF SAID CURVE TO THE LEFT IN A WESTERLY DIRECTION, A DISTANCE OF 142.40 FEET THROUGH A CENTRAL ANGLE OF $06^{\circ}09'27''$ TO THE POINT OF TANGENCY OF SAID CURVE; THENCE N $88^{\circ}51'34''$ W, A DISTANCE OF 104.64 FEET; THENCE N $00^{\circ}20'12''$ W, A DISTANCE OF 272.26 FEET TO THE POINT OF CURVATURE OF A CURVE TO THE LEFT WITH A RADIUS OF 1525.00 FEET; THENCE ALONG THE ARC OF SAID CURVE TO THE LEFT IN A NORTHERLY DIRECTION, A DISTANCE OF 155.50 FEET THROUGH A CENTRAL ANGLE OF $05^{\circ}50'32''$ TO THE POINT OF REVERSE CURVATURE OF A CURVE TO THE RIGHT WITH A RADIUS OF 1475.00 FEET; THENCE ALONG THE ARC OF SAID CURVE TO THE RIGHT IN A NORTHERLY DIRECTION, A DISTANCE OF 208.32 FEET THROUGH A CENTRAL ANGLE $08^{\circ}05'32''$; THENCE S $88^{\circ}50'54''$ E ALONG THE NORTH LINE OF SAID TRACT 56, A DISTANCE OF 561.88 FEET; THENCE S $00^{\circ}28'40''$ E ALONG THE EAST LINE OF SAID TRACT 56, A DISTANCE OF 639.29 FEET TO THE POINT OF BEGINNING.

LESS AND EXCEPT ANY PORTION OF THE ABOVE DESCRIBED PARCEL WHICH FALLS WITHIN THE PLATTED ROAD RIGHTS OF WAY AS PER PLAT OF POMELLO PARK, RECORDED IN PLAT BOOK 6, PAGE 61 OF THE PUBLIC RECORDS OF MANATEE COUNTY, FLORIDA.

BK 1543 PG 7240 71 of 75



201 5th Avenue Drive East
Post Office Box 9448
Bradenton, Florida 34206

(941) 748-8080
Fax (941) 748-3316
Survey Fax (941) 748-3747
E-mail: zns@manatee-cc.com
Web Page: www.manatee-cc.com/zns/

JANUARY 21, 1998

FOXWOOD

DESCRIPTION: PARCEL 73

TRACT 55, POMELLO PARK, SECTION 30, TOWNSHIP 35 SOUTH, RANGE 20 EAST, AS PER PLAT THEREOF, RECORDED IN PLAT BOOK 6, PAGE 61 OF THE PUBLIC RECORDS OF MANATEE COUNTY, FLORIDA, BEING MORE PARTICULARLY DESCRIBED AS FOLLOWS:

FROM THE SOUTHEAST CORNER OF SAID SECTION 30, RUN N 40°47'30" W, A DISTANCE OF 886.95 FEET TO THE POINT OF BEGINNING; THENCE N 88°50'54" W ALONG THE SOUTH LINE OF SAID TRACT 55, A DISTANCE OF 561.88 FEET TO A POINT ON THE ARC OF A CURVE TO THE RIGHT WHOSE RADIUS POINT LIES S 88°05'12" E, A DISTANCE OF 1475.00 FEET; THENCE ALONG THE ARC OF SAID CURVE TO THE RIGHT IN A NORTHERLY DIRECTION, A DISTANCE OF 92.48 FEET THROUGH A CENTRAL ANGLE OF 03°35'33" TO THE POINT OF REVERSE CURVATURE OF A CURVE TO THE LEFT WITH A RADIUS OF 1525.00 FEET; THENCE ALONG THE ARC OF SAID CURVE TO THE LEFT IN A NORTHERLY DIRECTION, A DISTANCE OF 155.50 FEET THROUGH A CENTRAL ANGLE OF 05°50'32" TO THE POINT OF TANGENCY OF SAID CURVE; THENCE N 00°20'12" W, A DISTANCE OF 387.32 FEET; THENCE S 88°51'08" E, A DISTANCE OF 545.87 FEET; THENCE S 00°28'40" E ALONG THE EAST LINE OF SAID TRACT 55, A DISTANCE OF 635.24 FEET TO THE POINT OF BEGINNING.

LESS AND EXCEPT ANY PORTION OF THE ABOVE DESCRIBED PARCEL WHICH FALLS WITHIN THE PLATTED ROAD RIGHTS OF WAY AS PER PLAT OF POMELLO PARK, RECORDED IN PLAT BOOK 6, PAGE 61 OF THE PUBLIC RECORDS OF MANATEE COUNTY, FLORIDA.

BK 1543 PG 7241 72 OF 75



201 5th Avenue Drive East
Post Office Box 9448
Bradenton, Florida 34206

(941) 748-8080
Fax (941) 748-3316
Survey Fax (941) 748-3747
E-mail: zns@manatee-cc.com
Web Page: www.manatee-cc.com/zns/

JANUARY 21, 1998

FOXWOOD

DESCRIPTION: PARCEL 74

A PORTION OF TRACT 54, POMELLO PARK, SECTION 30, TOWNSHIP 35 SOUTH, RANGE 20 EAST, MANATEE COUNTY, FLORIDA, AS PER PLAT THEREOF, RECORDED IN PLAT BOOK 6, PAGE 61 OF THE PUBLIC RECORDS OF MANATEE COUNTY, FLORIDA, BEING MORE PARTICULARLY DESCRIBED AS FOLLOWS:

FROM THE SOUTHEAST CORNER OF SAID SECTION 30, RUN N 23°19'51" W, A DISTANCE OF 1477.55 FEET TO THE POINT OF BEGINNING; THENCE N 88°51'08" W, A DISTANCE OF 545.74 FEET; THENCE N 00°20'12" W, A DISTANCE OF 419.31 FEET; THENCE N 83°57'10" E, A DISTANCE OF 547.07 FEET; THENCE S 00°28'40" E ALONG THE EAST LINE OF SAID TRACT 54, A DISTANCE OF 487.88 FEET TO THE POINT OF BEGINNING.

BK 1543 PG 7242 73 of 75



201 5th Avenue Drive East
Post Office Box 9448
Bradenton, Florida 34206

(941) 748-8080
Fax (941) 748-3316
Survey Fax (941) 748-3747
E-mail: zns@manatee-cc.com
Web Page: www.manatee-cc.com/zns/

JANUARY 16, 1998

FOXWOOD

DESCRIPTION: PARCEL 75

A PORTION OF TRACTS 44, 53 AND 54, POMELLO PARK, SECTION 30, TOWNSHIP 35 SOUTH, RANGE 20 EAST, AS PER PLAT THEREOF, RECORDED IN PLAT BOOK 6, PAGE 61 OF THE PUBLIC RECORDS OF MANATEE COUNTY, FLORIDA, BEING MORE PARTICULARLY DESCRIBED AS FOLLOWS:

FROM THE SOUTHEAST CORNER OF SAID SECTION 30, RUN N 17°42'56" W, A DISTANCE OF 1936.43 FEET TO THE POINT OF BEGINNING; THENCE S 83°57'10" W, A DISTANCE OF 547.07 FEET; THENCE N 00°20'12" W ALONG THE WEST LINE OF SAID TRACT 54, A DISTANCE OF 46.69 FEET TO THE POINT OF CURVATURE OF A CURVE TO THE LEFT WITH A RADIUS OF 525.00 FEET; THENCE ALONG THE ARC OF SAID CURVE TO THE LEFT IN A NORTHERLY DIRECTION, A DISTANCE OF 278.79 FEET THROUGH A CENTRAL ANGLE OF 30°25'34" TO THE POINT OF REVERSE CURVATURE OF A CURVE TO THE RIGHT WITH A RADIUS OF 275.00 FEET; THENCE ALONG THE ARC OF SAID CURVE TO THE RIGHT IN A NORTHERLY DIRECTION, A DISTANCE OF 89.79 FEET THROUGH A CENTRAL ANGLE OF 18°42'28"; THENCE N 76°55'19" E, A DISTANCE OF 663.95 FEET; THENCE S 00°28'40" E ALONG THE EAST LINE OF SAID TRACTS 53 AND 54, A DISTANCE OF 488.16 FEET TO THE POINT OF BEGINNING.

LESS AND EXCEPT ANY PORTION OF THE ABOVE DESCRIBED PARCEL WHICH FALLS WITHIN THE PLATTED ROAD RIGHTS OF WAY AS PER PLAT OF POMELLO PARK, RECORDED IN PLAT BOOK 6, PAGE 61 OF THE PUBLIC RECORDS OF MANATEE COUNTY, FLORIDA.

BK 1543 PG 7243 74 of 75

AL

LEGEND

 EQUESTRIAN TRAILS

 ROADS

FOXWOOD SITE PLAN

BK 1543 PG 7244 FILED AND RECORDED 02/11/98 2:51PM 75 of 75
 R.B. SHORE CLERK OF CIRCUIT COURT MANATEE COUNTY FL

SCALE: 1" = 700'

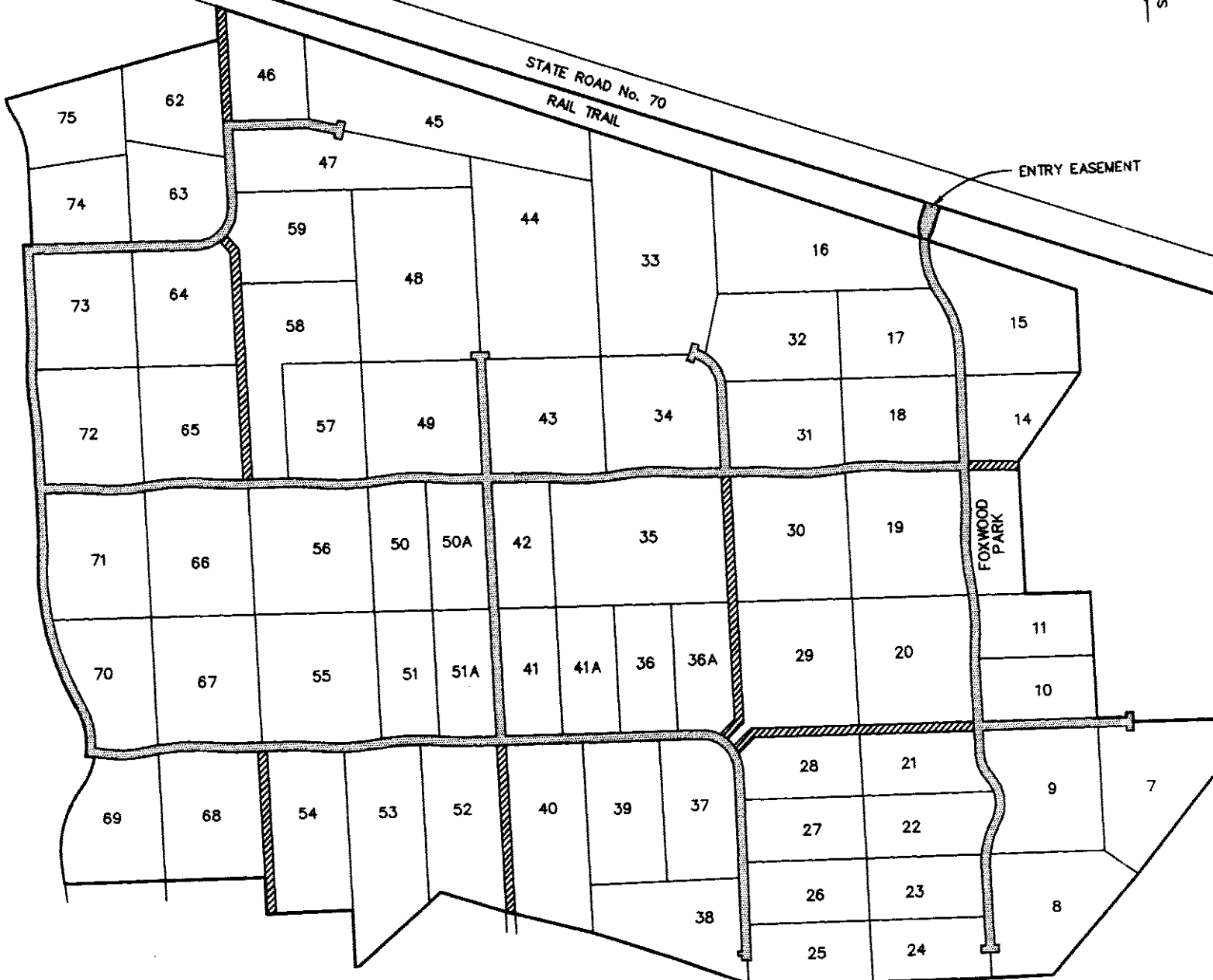

EXHIBIT B